

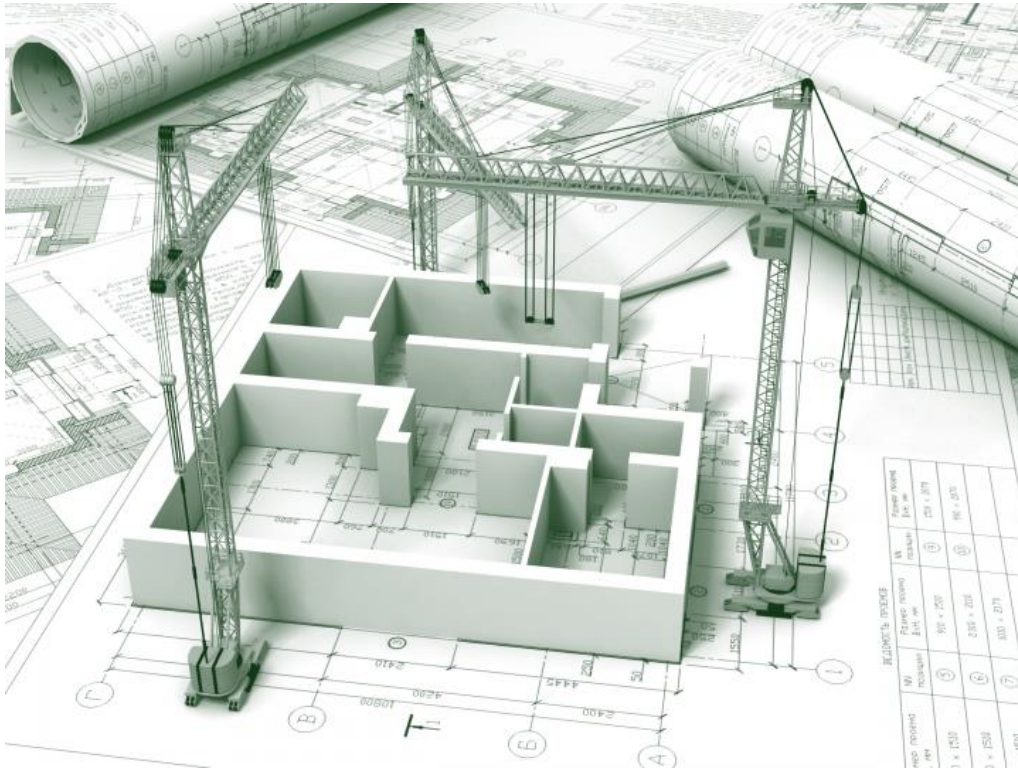

Rialtas na
hÉireann
Government
of Ireland

Tionscadal Éireann
Project Ireland
2040



Capital Plan 2024

Building and Equipment

Healthcare is an important part of Project Ireland 2040, the Government's long term, overarching strategy to make Ireland a better country for all and to build a more resilient and sustainable future. Project Ireland combines the National Planning Framework (the vision and strategy) and the National Development Plan (the investment). The Capital Plan, predominately funded from the NDP, provides significant public investment in health infrastructure to meet current needs, to cater for an estimated population growth of one million people and to respond to the changing demographic profile in Ireland. It will also support the realisation of a vision for a high quality, safe, accessible and sustainable healthcare system, enabled by capital funding.

In 2024, investment in healthcare infrastructure, equipment and furnishing of healthcare facilities is €1,161.80m from all funding sources.*

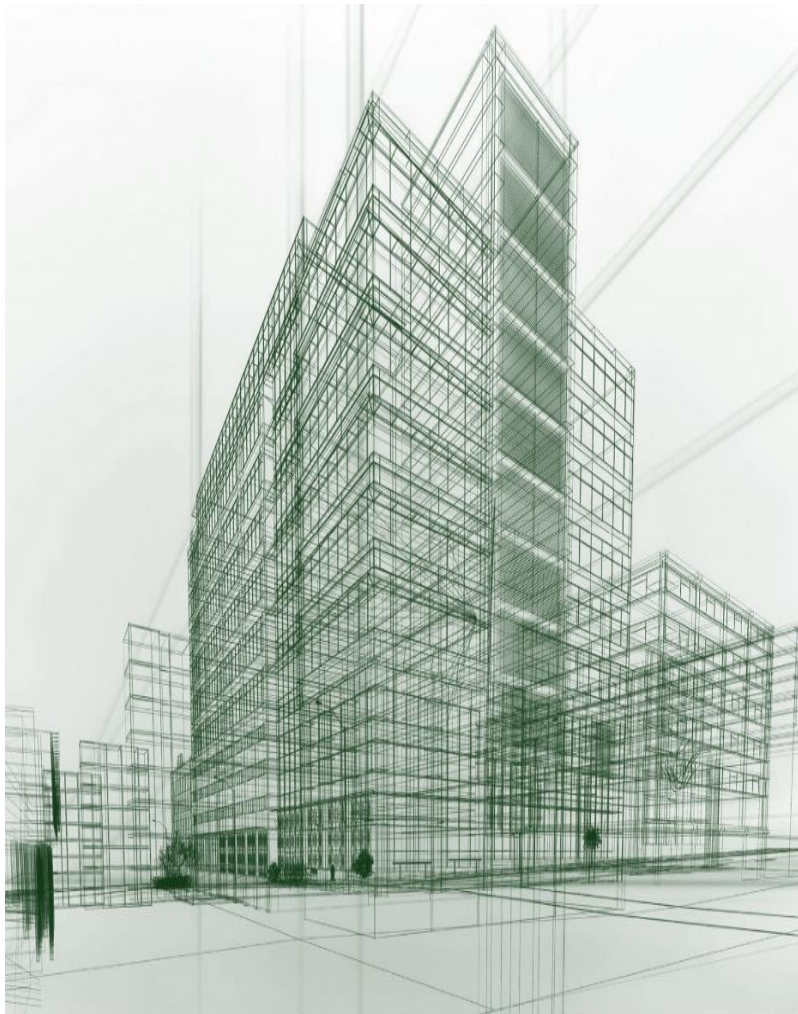

The 2024 HSE Capital Plan continues to place primary focus on the experience of patients, staff and everyone who engages with the HSE. Modern infrastructure and equipment are a crucial component of the provision of a safe and quality health service, a contributor to a positive patient experience and to staff wellbeing. The funding allocated for 2024 will progress and deliver a range of acute and community projects across the country. This investment will continue to provide increased capacity in the health system and support *Sláintecare* delivery and pathways to universal healthcare. A significant allocation of funding to prioritise patient safety and deal with risk is also provided, and includes the replacement of equipment and the ambulance fleet and infrastructure upgrades.

*Department of Health investment (Vote) in infrastructure, equipment and furnishing of health facilities in 2024 is €1,058.78m (includes €2.5m from Shared Island Fund). Department of Children, Equality, Disability, Integration and Youth investment (Vote) in specialist, disability health projects in 2024, is €23.02m. Income of €10m and a carryover of €70m from 2023 is also available. Refer to Tables 3.a.i and 3.a.ii on page 8.



TABLE OF CONTENTS

OVERVIEW	4
SECTION 1 - Introduction	5
SECTION 2 – Review of Capital Plan 2023	7
SECTION 3 – Capital Plan 2024.....	8
ENHANCING COMMUNITY SERVICES	13
DISABILITY SERVICES	15
ACUTE HOSPITAL CARE	17
CROSS SERVICES CARE AREAS	21
CHILDREN’S HEALTH & WOMEN’S HEALTH.....	23
ENABLERS	24
APPENDICES	26

OVERVIEW

The Capital and Estates function prepares the HSE annual Capital Plan in conjunction with operational services, taking account of contractual commitments, investment priorities and funding available. In 2024, the total investment in healthcare infrastructure, equipment and furnishing of health facilities from all funding sources is €1,161.80m.¹ This funding is managed to achieve value for money in accordance with the Public Spending Code (Infrastructure Guidelines) and the Capital Projects Manual and Approvals Protocol of the HSE. The Capital Plan, derived from the Programme for Government, aligns to the strategic priorities of the HSE and supports the delivery of safe and quality healthcare. In tandem with the capital allocation received, Capital and Estates also manage funding from a revenue stream to maintain and expand the existing healthcare estate and provide infrastructure for services to deliver increased community and primary care bed capacity.

The overarching objective for the HSE in the year ahead is the progression of all contractually committed projects, addressing known compliance and risk associated with healthcare infrastructure and continuing initiatives to support patient access to services. There is also a focus on the longer-term modernisation of the healthcare estate, aligned to population and service needs, allied to the Government commitment to net carbon zero by 2050.

Consistent with this focus, progress will continue on the delivery of the implementation plan for the Capital and Estates Strategy. The Strategy focuses on an innovative and progressive approach to capital infrastructure planning, to support the development of new facilities and the modernisation and optimum utilisation of existing buildings. Along with implementation of the Department of Health's Strategic Healthcare Investment Framework, and the six new Health Regions, balanced consideration of future investment is enabled by promoting a strategic approach to planning. In addition, the Infrastructure Decarbonisation Strategy and Implementation Roadmap, is progressing in partnership with the Sustainable Energy Authority of Ireland, to make the HSE more energy efficient and sustainable and meet Government climate action targets.

Capital Plan 2024 supports the construction of Government priority projects including, the New Children's Hospital, advancement of the National Maternity Hospital and enablement of other key initiatives consistent with universal healthcare. Funding is provided for specific priority programmes including; Critical Care, Surgical Hubs, Urgent Emergency Care, Elective Hospitals, Specialist Disability Services, Enhanced Community Care, Primary Care, Older Persons and Mental Health. There is investment for additional bed capacity projects, with many of these in progress. Managing patient safety and mitigation of clinical and infrastructural risk are fundamental, while investment in minor capital initiatives, delivery of the equipment replacement programme and the ambulance replacement programme is sustained to support this. Additional revenue funding is also provided for technical and support resources to enable delivery of the Capital Plan.

Maintaining efficient oversight and effective management of the Capital Plan in the year ahead will be critical to ensuring delivery of prioritised projects. Challenges associated with securing skilled resources for projects, external factors such as construction inflation, and contractor capacity within the construction sector, continue to be monitored. In conjunction with Government, the HSE also continues to examine options for more efficient delivery of the Capital Programme. The HSE recognises that the provision of safe, secure and high quality infrastructure to support current and future population healthcare needs, plays a key role in improving the experience and outcomes for patients, service users and staff. Delivering this objective, while achieving value for money and compliance is a primary goal of Capital Plan 2024.

¹ Department of Health investment in infrastructure, equipment and furnishing of health facilities in 2023 is €1,058.78m, including €2.5m from the Shared Island Fund. Department of Children, Equality, Disability, Integration and Youth investment in specialist, disability health projects in 2023 is €23.02m. This is a total investment of €1,161.80 and includes €10m in income and €70m carryover from 2023. Refer to Tables 3.a.i and 3.a.ii on page 8.

SECTION 1 – Introduction

This section of the Plan outlines the strategic context in which Capital Plan 2024 has been prepared, reflecting significant organisational priorities and operational factors. It also takes account of the HSE *Corporate Plan 2021-2024*, *Sláintecare* and the *Government Climate Action Plan 2021*. The content of this Plan is also informed by engagement and discussion with the Department of Health and the Department of Children, Equality, Disability, Integration and Youth.

The transition to regional health structures in 2024 will require consideration of capital projects on a regional basis. Engagement with regional health structures is anticipated to align current processes on to future structures. Future structures should continue to support existing arrangements in place to ensure effective governance and delivery of the Capital Plan.

STRATEGIC CONTEXT

National Planning Framework: The National Planning Framework guides high-level strategic planning and development for the country, seeking to ensure that as the population grows, facilities and infrastructure are in place to meet that growth. The National Planning Framework, alongside the National Development Plan, are together one plan, guiding strategic development and infrastructure investment at national level. The vision, set out under the Framework will ensure Ireland's long-term social progress for all parts of the country, and is consistent with the projected one million increase in population by 2040. It draws upon lessons learned from the National Spatial Strategy and highlights a vision of success based on better choices compared to a 'business as usual' approach.

Universal Healthcare and Sláintecare: The overarching vision and long-term policy direction for Ireland's healthcare system is the achievement of universal healthcare set out in the Programme for Government. The Implementation Strategy identifies capital investment as a critical enabler of the reform proposed in *Sláintecare*, acting as a catalyst for implementation of a revised model of care and modernisation of service delivery. A major principle of *Sláintecare* is the achievement of best health outcomes and value for money by re-orienting the model of care towards primary and community care, meeting the majority of population health needs, in a local and integrated system.

HSE Corporate Plan: The HSE Corporate Plan for the period 2021-2024 sets out a vision and strategy for service delivery and outlines the aims of the organisation for the period. The transformation described in the Corporate Plan focuses on enabling the delivery of *Sláintecare* by moving care from a hospital to a community setting, addressing access to care and ensuring value for money. The Corporate Plan provides a context for necessary capital developments in primary, community and acute settings, including the construction of new or expanded facilities.

HSE Capital and Estates Strategy: The HSE Capital and Estates Strategy focuses on an innovative and progressive approach to capital infrastructure planning. The HSE Board adopted this Strategy and accompanying Implementation Plan in 2022. The Strategy adopts a strategic long-term view of investment decisions to 2050, incorporating rolling 5-year interim review cycles. It supports the modernisation and optimum utilisation of existing infrastructure by creating opportunities to maximise assets, generate efficiencies, develop synergies, and produce improvements as necessary. It also supports the development of new facilities where required. The Strategy will also support a balanced and regional approach to future investment by promoting a strategic approach to planning. Delivering on objectives outlined in the Strategy will be achieved by building upon the Strategic Assessment Framework principles and adopting the Department of Health multi-criteria Strategic Healthcare Investment Framework.

HSE Climate Action Strategy and Infrastructure Decarbonisation Roadmap: The Government Climate Action Plan 2021 and the Climate Action and Low Carbon Development (Amendment) Act 2021, are aligned with the European Green Deal, which establishes European Commission policy initiatives. The overarching aim of this is to make the European Union climate neutral by 2050. The Government Climate Action Plan sets out the energy efficiency and energy related Green House Gas emissions reduction targets, which Public Sector Bodies in Ireland are legally obliged to meet. The HSE as a public body is mandated to develop a roadmap, setting out how it will deliver these targets and an Infrastructure Decarbonisation Roadmap is in place in response to this obligation. It outlines the work undertaken by the HSE to date and the future approach to reduce carbon emissions from buildings and operationally reduce energy usage and move to carbon zero energy. The Infrastructure Decarbonisation Roadmap, delivered in conjunction with the Sustainable Energy Authority of Ireland, is an integral part of the Capital and Estates Strategy and the wider HSE Climate Action and Sustainability Strategy.

Capital Plan: The Capital Plan, reviewed annually derives from the Programme for Government and is a one-year plan within the delivery of the HSE Capital Programme. Framed within the context of delivering universal healthcare, the Plan takes account of strategic projects and programmes, as well as recent Government priorities such as surgical hubs, elective hospitals, capacity expansion, women's health and other initiatives. Capital funds advanced to the HSE each year are for the delivery of core capital infrastructure and equipping, outlined to an approved level of expenditure, under various sub headings in the annual Letter of Determination. Capital and Estates has engaged with the Health Infrastructure Division of the Department of Health in developing this Capital Plan and this engagement will continue with ongoing progress reporting on delivery and performance throughout the year. The HSE Board provided approval for the Plan, which was forwarded to the Minister for Health for review and approval in accordance with the Health Act 2004, as amended by the Health Service Executive (Financial Matters) Act 2014. The delivery of the Capital Plan, once approved by the HSE and the Minister, is primarily the responsibility of the National Director, Capital and Estates.

Governance Procedures: Management of the Capital Programme is in accordance with a suite of protocols, listed below:

- √ Public Spending Code (Infrastructure Guidelines)
- √ HSE Projects Manual and Approvals Protocol
- √ HSE National Financial Regulations
- √ Capital Works Management Framework
- √ Public Private Partnership Guidelines
- √ HSE Property Protocol

Project Governance: It is the role of the HSE National Capital and Property Steering Committee to appraise all project submissions, ensure compatibility with HSE service priorities, monitor compliance with policies and recommend the selection of projects for inclusion within the Capital Plan, ensuring alignment with the National Service Plan. The established protocols governing the appraisal, initiation, management and administration of all capital projects are those referenced above.

SECTION 2 – Review of Capital Plan 2023

The Capital Plan 2023 was prepared in the context of the expected pressures on our services associated with delivering projects to support the continuing requirement to increase capacity and the need to improve access to services. Capital and Estates continued to work with all Service groups, to respond comprehensively to ongoing challenges and create an environment that enabled and supported service provision.

Capital Plan 2023

The capital (vote) allocation for 2023 was €1,022.54m including supplementary funding. A breakdown is in Table 2.a.

Table 2.a – Capital Allocation 2023

Capital Allocation 2023	€m
Original Core Allocation*	967.00
COVID-19 Capital Funding	50.00
Brexit (Aseptic Compounding Units)	5.54
M1 Transfer from DoH to HSE	3.84
Total Available Funding	1,026.38

*Funding of €21.37m was allocated from the above original core allocation to DCEDIY

The Department of Health provided supplementary capital funding of €21.682m to the HSE in 2023 for onward provision to the OPW. This funding was provided to support health elements of Brexit capital projects delivered by the OPW. This supplementary funding is eligible for reimbursement under the Brexit Adjustment Reserve (BAR) Fund from the European Commission.

Throughout each year, the HSE actively manages and monitors progress and performance on each project included in the Capital Plan. The Q2 2023 management review noted that projected year-end expenditure was behind profile. The primary reason for this was the lower than projected funding requirement of the New Children's Hospital, based on contractor performance. In July 2023, the HSE Board approved the reallocation of infrastructure capital funding as set out in Table 2.b, to ensure utilisation of the full 2023 Capital Plan allocation.

Table 2.b – Capital Re-allocation 2023

Category	€m
Government and HSE Priority – Surgical Hubs (not included in Capital Plan 2023)	10.00
Government and HSE Priority – Additional Acute Bed Capacity (not included in Capital Plan 2023)	4.00
Wexford General Hospital Restoration – Additional to Insurance (not included in Capital Plan 2023)	6.00
Minor Capital – Acute and Non Acute: Additional to the provision in 2023 Capital Plan	25.00
Infrastructure Risk Projects (Fire, Structural, Mechanical and Electrical)	10.00
Initiation of New Priority Projects	35.00
Equipment Replacement Programme	18.00
Ambulance Replacement Programme	6.00
Strategic Property Acquisitions (subject to separate approvals process)	50.00
Total Re-Allocated Funding	164.00

Expectations are that the capital allocation will be utilised fully by the HSE in 2023. The Department of Public Expenditure NDP Delivery and Reform and the Department of Health have agreed that €70m from the Health Vote is carried forward to 2024. Through the viring process, €30m is being transferred from Capital Infrastructure to eHealth, for infrastructure projects within the Health Vote.

SECTION 3 – Capital Plan 2024

Context for Capital Plan

The Capital Plan for 2024 takes cognisance of priorities for Government, in particular; *Sláintecare* initiatives to improve and provide high quality infrastructure, as well as the HSE Corporate Plan 2021-2024 and the 2024 Letters of Determination. This section of the Plan focuses on capital investment programmes and projects funded in 2024. Priorities identified are the result of an ongoing process of engagement with the Minister for Health and the Minister for Disability, Children, Equality, Integration and Youth, Community Health Organisations and Hospital Groups, divisions in the HSE centre, and with the Department of Health and Department of Children, Equality, Disability, Integration and Youth. Progression of all projects will be in accordance with the Public Spending Code (Infrastructure Guidelines).

Capital Plan 2024

The Letters of Determination 2024, issued from the Department of Health on 28 November 2023 and the Department of Children, Equality, Disability, Integration and Youth on 3 December 2023, set out the level of capital funding available for building, equipping and furnishing. The breakdown of the funding is outlined in Table 3.a. (i) and 3.a. (ii)

Table 3.a. (i) – Letter of Determination - Department of Health
Capital Allocation 2024

Funding Category	Department of Health €m
Building, Equipping & Furnishing Allocation (Vote)	1,058.78*
Funding Carryover from 2023	70.00
Income	10.00
Total Available Funding	1,138.78

*Includes €2.5m from Shared Island Fund

Table 3.a. (ii) – Letter of Determination - Department of Children, Equality, Disability, Integration and Youth
Capital Allocation 2024

Funding Category	Department of Children, Equality, Disability, Integration and Youth €m
Building, Equipping & Furnishing Allocation (Vote)	23.02
Total Available Funding	23.02

The annual Capital Plan submitted to the Department of Health and the Department of Children, Equality, Disability, Integration and Youth takes in to account contractual commitments, investment priorities and funding available. Following the allocation of funding to meet all contractual commitments, priority is given to:

- Ambulance replacement: €14.5m;
- Equipment replacement programme: €65.00m;
- Infrastructural risk: €72.04m;
- Climate action: €29.65m;
- Urgent and Emergency Care: €2m.

Remaining funding is allocated to projects prioritised by the National Capital and Property Steering Committee in accordance with agreed criteria (refer to Table 3.c.). The funding in each category is summarised in Table 3.b.

Table 3.b. – 2024 Capital Plan Categories

2024 Capital Plan Categories and Recommended Funding Allocation	€m
Acute Projects	473.38
Ambulance Replacement	14.50
Ambulance Projects	11.55
Climate Action	29.65
Community Care (HIQA) Older Persons	94.50
Community Services	11.16
Disability Shared Projects	0.09
Enhanced Community Care	27.44
Equipment Replacement Programme	65.00
Health and Wellbeing	2.59
Infrastructural Risk	72.04
Mental Health	29.62
National Maternity Hospital to St. Vincent's University Hospital	24.54
New Children's Hospital	209.47
Primary Care	40.92
Primary Care – Public Private Partnership	16.80
Radiation Oncology	11.03
Urgent and Emergency Care Programme	2.00
Shared Island Fund	2.50
Sub-Total Department of Health Vote	1,138.78
Community Based Specialist Disability Services (includes De-congregation)	23.02
Total	1,161.80

Capital Plan 2024 Prioritisation Process

The Capital Plan contains projects approved by the HSE National Capital and Property Steering Committee. This is in accordance with the process outlined in the introductory section of this document. Prioritisation and re-profiling of some projects is necessary to remain within allocation. All projects, in accordance with priority were evaluated and ranked. During the prioritisation process, consideration was given to the following in compiling Capital Plan 2024:

- Contractual commitments, i.e. all projects in construction, including the cost of equipping these projects;
- Infrastructural risk projects which are deliverable through the Minor Capital Programme;
- The level of funding required and as set out in the National Equipment Replacement Report 2016;
- The level of funding required and as set out for the Ambulance Replacement Programme 2020;
- The Climate Action Programme;
- The Urgent and Emergency Care Programme;
- Funding contractually committed to the Primary Care Centre and Community Nursing Programmes under Public Private Partnership Unitary Payments;
- Additional acute capacity programmes;
- Funding to progress projects in design;
- The capital allocation for specialist community based disability services;
- Progression of projects and programmes listed in the NDP 2021-2030;
- Projects that will enable the achievement of universal healthcare, including *Sláintecare*.

Following the allocation of funding to meet all contractual commitments and priority programmes, the remainder of the funding is allocated to projects, which have been prioritised by the National Capital and Property Steering Committee, in accordance with criteria agreed with the Department of Health, recognising Government and Ministerial priorities. These criteria are in Table 3.c. A number of project evaluation teams formed by care group, undertook the project prioritisation process for 2024.

Table 3.c. – 2024 Project Prioritisation Criteria

2023 Project Prioritisation Criteria	Weighting
1. Patient Safety and Clinical Risk	1.0
2. Regulatory Requirement and Compliance	1.0
3. Alignment with universal healthcare objectives, including <i>Sláintecare</i>	0.8
4. Infrastructural Risk	0.8
5. Deliverability and Timescale	0.2
6. Climate Action and the requirement for Net Zero Carbon by 2050	0.2

Challenges

There are a number of challenges associated with the delivery of Capital Plan 2024, including:

- The final 2023 expenditure out-turn, which could impact the projected expenditure in 2024 and beyond;
- Fluctuation in expenditure on the New Children's Hospital, which would have a significant impact on the remainder of the Capital Programme, and Capital Plan 2024;
- The impact of current and future construction inflation on all projects;
- Climate action deliverables and the measures required to achieve the 2030 and 2050 targets;
- The transition to Health Regions in 2024 will require new processes, new ways of working and variation in roles and responsibilities;
- Increasing costs associated with new building standards and building regulations;
- The introduction of additional requirements to provide necessary project assurances in the revised Public Spending Code (Infrastructure Guidelines), which may have an impact on project timelines, especially in relation to ensuring compliance for longstanding / legacy projects;
- Sustainable levels of skilled resources within Capital and Estates required to oversee delivery of the Capital Plan;
- Availability of labour and specialised resources within the construction sector to enable project delivery;
- Clinical or infrastructural requirements, yet to be identified and unfunded in this Plan.

Ongoing Management

The inherent uncertainties associated with undertaking infrastructure projects, coupled with dynamic market conditions poses several challenges in respect of the management of the Capital Plan. This requires continuous management and review of the Capital Plan, undertaken through systematic, regular and timely management reviews for all projects and re-allocation of funding when required. This ensures the significant investment in health infrastructure is fully utilised to enable the delivery of high quality, safe, accessible and sustainable healthcare facilities.

Climate Action and Sustainability

The Government's Climate Action Plan sets out the energy efficiency and energy related green-house gas (GHG) emissions reduction targets, which public sector bodies in Ireland are legally obliged to meet. The HSE is mandated as a public body, to develop a roadmap, setting out how it will deliver these targets.

An Infrastructure Decarbonisation Roadmap developed by the HSE, outlines work undertaken to date and the continuing approach to reducing carbon emissions from healthcare buildings. This will be achieved with measures to reduce energy consumed by new and existing buildings, shifting energy sources away from fossil fuels towards renewable and carbon zero energy sources. Targets are classified as:

- Reducing energy related Green House gas emissions by 51% in 2030. These are Scope 1; direct energy related emissions from fuel (oil, gas, coal etc.), and Scope 2; indirect energy related emissions from electricity used in HSE owned and leased buildings, vehicles and equipment, energy used for heating, catering, and the delivery of clinical services;
- Increasing and improving energy efficiency in the HSE from the 33% target in 2020 to 50% by 2030;
- The non-installation by the HSE of heating systems that use fossil fuels after 2023, in (1) new buildings, and (2) "major renovation" retrofit projects unless in defined exceptional circumstances.

As part of the ongoing work to reduce carbon emissions from buildings within the estate, the HSE are taking forward a Deep Energy and Carbon Retrofit, Pilot Pathfinder Programme at ten identified healthcare sites in partnership with the Sustainable Energy Authority of Ireland. Technical advisors and design teams currently engaged are progressing designs advising on the retrofit works necessary to improve energy and emissions performance on these sites, towards achieving targets set out in the Climate Action Plan. This exercise will also assess and evaluate viable technical solutions suitable for use in healthcare environments, so that a scaled up, evidence based, costed, deep energy and carbon retrofit programme can be developed.

The HSE has also amended its design team technical requirements and scope of service for all developments requiring design teams to not only conform with all current building legislation and standards, but also to demonstrate that all new buildings and major refurbishments are designed to be carbon zero ready.

In 2024, we will:

- Progress the Deep Energy and Carbon Retrofit, Pilot Pathfinder Programme in partnership with the SEAI
- Develop a scaled-up, costed, Deep Energy and Carbon Retrofit Programme
- In line with revised technical requirements, ensure all facilities are designed to omit fossil fuels and that a clear roadmap exists for all new projects to be net zero carbon to meet obligations for 2030 and 2050
- Support Energy Management Teams through the continued progression of an energy shallow retrofit programme which delivers LED lighting, window and insulation upgrades, heat pump installations and Photovoltaic systems

ENHANCING COMMUNITY SERVICES

Primary Care

Primary care is an integral component of *Sláintecare*, reflected in the 2024 HSE National Service Plan. Primary care delivers care and supports to people close to home, across the continuum of their lives through a community-based approach. Primary Care incorporates GP services, in addition to a wide range of diagnostic, treatment and support services including dental, audiology, ophthalmology, child psychology and therapy services. The provision of infrastructure (primary care centres), also provides accommodation for a range of services including, community mental health services, disability services, environmental health services, accommodation for Tusla, ambulance rapid deployment points and civil registration services. Capital funding is provided to equip these primary care centres on completion. Provision is made in the 2024 Capital Plan for the unitary payment for primary care centres already delivered via public private partnerships.

In 2024, we will:

- Provide €40.92m for primary care projects
- Maintain the programme of construction for primary care centres, via the traditional funding model
- Maintain revenue investment for the construction of primary care centres through the operational lease mechanism
- Support the existing Public Private Partnership model by providing €16.80m in unitary payments for primary care centres
- Deliver and commission new primary care centres, (refer to Appendix 4) – a key performance measure for the HSE

Enhanced Community Care

The Enhanced Community Care Programme aims to deliver increased levels of healthcare with service delivery reoriented towards general practice, primary care and community-based services. The focus is on an end-to-end pathway that will avoid admission to acute hospitals, where it is safe and appropriate to do so.

In 2024, we will:

- Provide €27.44m to deliver accommodation solutions for ECC teams
- Continue engagement and collaboration with CHO's and Health Regions on interim accommodation requirements to advance projects
- Progress approved, permanent solutions to accommodate ECC teams in accordance with the HSE Capital and Property Approvals Protocols and Public Spending Code (Infrastructure Guidelines), (refer to Appendix 1 & 2)

Social Care – Older Persons

Older Persons' Services contribute to the continued enhancement of community care services by implementing and delivering a new integrated model of care for older persons, which enables increased access to care and supports, at home and in the community. This means fewer people admitted to hospitals and more people discharged to their home and community settings. The HSE and the Department of Health are maintaining progress on the programme of investment in public residential care, recognising the requirement for HIQA regulatory compliance. The HSE and the Department continue to update plans for the completion of the Community Nursing Unit (CNU) Programme and the CNU Public Private Partnership Programme. Planning for a ten-year capital programme for additional community capacity in Long Term Residential Care will be progressed in 2024. The HSE and the Department are also committed to progressing a community based funding package to support a refurbishment programme, including upgrades to food preparation and equipment for Older Persons Community Day Centres.

In 2024, we will:

- Provide €94.50m for investment in public residential care
- Continue construction work on all CNU sites for the provision of community older person's beds through the public private partnership process
- Continue to progress the community nursing unit, infrastructure regulatory compliance programme by delivering improved accommodation

Mental Health Services

Mental health services promote positive mental health and provide accessible, comprehensive and community-based health services for those who need them. The range of mental health services delivered by, or on behalf of the HSE, covers specialist inpatient services, day hospitals, residential services, services within community settings and in primary care, as well as non-specialist supports and services. Many of these services are provided in collaboration with funded partner organisations. Planning for a new mental health ten year Capital Programme will be progressed in 2024, with a focus on upgrading existing facilities and continued implementation of Mental Health Commission recommendations in existing units.

In 2024, we will:

- Provide €29.62m for a significant range of developments to support mental health service delivery
- Enable the provision of mental health services by providing fit for purpose infrastructure
- Continue a programme of anti-ligature works across all facilities

DISABILITY SERVICES

Specialist Community-Based Disability Services are delivered through the HSE, Section 38, and Section 39 private providers. A range of specialist disability services are provided to circa 80,000 people with physical, sensory, intellectual disabilities and autism. These span residential, home support and personal assistant services, clinical and allied therapies, neuro-rehabilitation services, respite services, day services and rehabilitative training. The primary goal of disability services is to improve access for children and adults to essential services, to ensure they have the opportunity to maximise their potential to live as independently as possible, as equal citizens. Specialist disability services focus on providing supports to people with more complex disabilities and aim to complement the mainstream health and social care services provided to people with disabilities alongside the rest of the population.

Specialist Community-Based Disability Services transferred to the Department of Children, Equality, Disability, Integration and Youth (DCEDIY) in March 2023. All capital funding is provided by the DCEDIY and ring-fenced for disability projects only, with the goal of expanding and transforming disability services to meet current and future need.

This Capital Plan aims to reflect the priorities within the National Development Plan. It also reflects the priorities set out in the Action Plan for Disability Services, 2024-2026, which was published in December 2023. HSE Capital and Estates will engage with operational Service colleagues and DCEDIY to progress the development of a disability specific, multi-annual capital strategy during 2024, which will identify the medium term infrastructure needs for disability services.

Resources required to progress this multi-annual capital strategy, and which are key to the delivery of disability specific initiatives, will be assessed in 2024.

To support an increase in the pipeline of disability capital projects in 2024, the HSE National Capital and Property Steering Committee will review capital submissions received for disability projects more frequently than the current schedule of meetings. Capital submissions to increase the project pipeline will be subject to appropriate project appraisal, assessment of suitability to advance, development of business case and compliance with the Public Spending Code (Infrastructure Guidelines). Project locations under consideration for inclusion in the pipeline are, Cork (Kanturk); Galway (Athenry, Craughwell and Tuam); Kerry (Beaufort); Roscommon; Meath (Kilcloon) and Dublin.

A Department of Health approved de-congregation programme to provide residential accommodation in the community for residents of institutional congregated settings has been underway since 2016. To date, 130 properties have been provided, with a further 29 in the pipeline. Investment to date is approximately €66.4m. The focus is on de-congregation from locations with the greatest non-compliance issues, where the priority has been the purchase of houses in the community and the adaptation of these houses to suit the requirements of residents. The programme has been impacted by the recent, general low availability of suitable housing stock, but will continue, as committed in 2024.

In 2024, we will:

- Provide €23.02m to support specialist community based disability services
- Increase disability capital project pipeline
- Continue the transition of people from institutional settings to community-based services in line with the *Time to Move on from Congregated Settings* policy

- Continue engagement with local authorities and approved housing bodies to avail of additional Government funding through the Capital Assistance Scheme
- Enable disability service delivery by providing accommodation for disability network teams, therapy and day services
- Continue to progress the recruitment of resources, key to the delivery of disability specific initiatives

ACUTE HOSPITAL CARE

Capital Plan 2024 provides funding to support all aspects of acute hospital care, including outpatient and laboratory services, (pathology, blood sciences), in-patient accommodation and theatres.

In order to improve patient flow and ensure sufficient capacity to meet scheduled and unscheduled patient demand a plan is in development to expedite the planning and construction of additional acute beds across the country.

In 2024, we will:

- Construct additional acute beds across the system – a key performance measure for the HSE
- Progress the design and works of planned additional and replacement acute inpatient beds. This follows the launch of the Acute Hospital Inpatient Expansion Plan 2024-2031 ([link](#)) by the Minister for Health, and is aligned to the additional capital funding of €245m in the NDP allocations for 2024, 2025 and 2026 agreed by Government. The profile is outlined in table 3.d.

Table 3.d

Acute Inpatient Additional Beds Planned for Delivery 2024-2031								
2024	2025	2026	2027	2028	2029-31	Total New	Replacement	Total All
127	284	223	476	812	1,516	3,438	929	4,367

- Continue progress at University Hospital Limerick with the expected completion of 16 Beds by end 2024. Construction is progressing on Block A, (96-beds), expected to complete construction in Q1 2025. Planning permission is lodged for Block B (96-beds - Phase 2), and enabling works will continue in 2024. The HSE is continuing to explore all opportunities to accelerate the provision of in-patient capacity
- Oversee and steer the delivery of a refreshed infrastructural masterplan for University Hospital Galway through the established Capital Programme Oversight Board by the Saolta Hospital Group. The process of appointing a Senior Project Manager, who will lead and manage the development of the masterplan, is ongoing, with a target for substantial completion of this initiative by Q4, 2024. A design team is also appointed to progress an updated Development Control Plan for the University Hospital Galway campus
- Progress to tender the radiology project at the National Orthopedic Hospital Cappagh (NOHC). The larger NOHC multi-storey ward and theatre block project will have a design team appointed, with a view to progressing to planning in 2024
- Continue the plan already underway, to progress Minor Injury Units nationwide

Critical Care

The Strategic Plan for Critical Care aims to increase critical care capacity nationally over two phases of capacity expansion. Phase one includes; Tallaght University Hospital, the Mater Misericordiae University Hospital, and St Vincent's University Hospital. Further beds, subject to necessary approval processes, will be provided in phase two at five prioritised sites: St. Vincent's University Hospital, the Mater Misericordiae Hospital, St. James's Hospital, Beaumont Hospital and Cork University Hospital.

In 2024, we will:

- Continue development of critical care capacity in line with the National Strategic Plan for Critical Care
- Construct new beds, (refer Appendix 1) – a key performance measure for the HSE
- Progress the design processes for new beds, (refer Appendix 2)
- Progress a submission for HDU/ICU beds in Letterkenny University Hospital

Urgent and Emergency Care

A multi-annual Urgent and Emergency Care (UEC) Plan is part of a new UEC Programme that has followed best practice in health service and system improvement. It envisions an urgent and emergency care service, within newly established Health Regions, integrated around patients' needs. The move toward a more integrated health system, organised into six HSE Health Regions is timely in the context of improvement, based on integrated care design, focused on patients and informed by the needs of the local population.

In 2024, we will:

- Progress the design of new emergency departments nationally, (refer Appendix 1 & 2), including, Beaumont Hospital and University Hospital Galway, and carry out feasibility reviews at other locations such as University Hospital Kerry
- Provide funding to enable and support the UEC Programme
- Support the delivery of community based in-patient rehabilitation services

Trauma Services

The planned delivery of trauma-related clinical expertise will be through two regional Trauma Networks where facilities and services co-ordinate the care of injured patients along standardised pathways. This includes continuing to develop the Planned Trauma Care (PTC) service in Cork and commencing planning for the PTC service in Galway as part of the development of a Trauma Unit with Specialist Services (TUSS) at University Hospital Galway.

In 2024, we will:

- Provide funding to address the delivery of trauma services, set out in the *Trauma System for Ireland* report
- Progress the design processes for the major trauma centres in Dublin and Cork

Cancer Services

The National Cancer Control Programme (NCCP) leads on the implementation of the *National Cancer Strategy 2017-2026*, working collaboratively and engaging with service users, external stakeholders, and acute and community services. Cancer services are designed and delivered through 9 cancer centres, and in a further 16 public hospitals for systemic anti-cancer therapy (including chemotherapy and immunotherapy). Radiotherapy is provided at 7 centres nationally, informed strategically by the National Plan for Radiation Oncology. Rolling capital investment, reviewed annually, will aim to ensure that cancer facilities meet patient requirements and respond to new, evidence-based treatment opportunities.

In 2024, we will:

- Support the commitment in the Programme for Government, included in the National Development Plan 2021-2030 for the development of cancer centres
- Provide funding to support the provision of new radiation oncology facilities in Dublin
- Continue investment in the Linear Accelerator Replacement Programme in Dublin and Limerick
- Support the development of Aseptic Compounding Units, (refer to Appendix 1 & 2)

Scheduled Care – Surgical Hub Programme

The management of waiting times for scheduled care remains a significant challenge for the HSE. Despite these challenges, positive progress is being made, due to a new multi-annual action plan. Waiting lists for scheduled care in hospitals increased between 2015 and 2021 creating huge backlogs. This trend has now been halted and overall waiting lists and waiting times are decreasing, supporting timely and transparent access to high-quality scheduled care, where and when it is needed. The targeted expansion of operational and physical capacity is a key enabler to support a sustainable reduction in waiting times.

In 2024, we will:

- Continue to advance significant infrastructure developments, including surgical hub facilities to support scheduled care initiatives
- Progress the design and contract approval of identified and approved surgical hub facilities. Two are in construction - Dublin South and Dublin North and tenders have been received for the other four - Waterford, Cork, Limerick and Galway, (refer to Appendix 1 & 2)

Elective Hospital Programme

As part of the *Sláintecare* National Elective Ambulatory Care Strategy, new elective hospitals are proposed in Cork, Galway and Dublin. This will change the way in which day case, planned procedures, surgeries, scans and outpatient services are delivered, ensuring greater capacity in the future and helping to address waiting times for scheduled care. As sponsoring agency, the HSE will continue to support the Department of Health in the development of these dedicated, standalone elective centres as part of a sustainable model, and the strategic response to catering for the evolving healthcare needs and treatment of an increasing population.

In 2024, we will:

- Progress the design and development of Elective Care Centre's in Cork, Dublin and Galway in accordance with the Public Spending Code (Infrastructure Guidelines) approvals process

Diagnostics

An overarching priority within acute services is the provision of diagnostics including endoscopy and radiology capacity to support access, early detection of disease, patient flow and capacity. Funding is provided to support increasing laboratory capacity.

In 2024, we will:

- Fund projects across the spectrum of acute services to provide diagnostic facilities, (refer to Appendix 1 & 2)
- Fund community diagnostic facilities to support delivery of an integrated model of care

CROSS SERVICES CARE AREAS

National Ambulance Service

The National Ambulance Service, (NAS) serves the needs of patients and the public as part of an integrated health system through the provision of high quality, safe and patient-centred services. The NAS is currently undergoing a significant transformation programme, with a new NAS Strategic Plan currently being finalised. The new Strategy will set out an implementation plan to meet service demands and support universal healthcare. Building on the clinically led model of patient care, the NAS will continue to ensure that care provision is in the most appropriate place with further development of alternative care pathways.

In 2024, we will:

- Provide €14.50m to maintain the current ambulance fleet
- Continue planning and engagement with NAS, to progress prioritised capital developments
- Allocate €11.55m to support the provision of new infrastructure and the modernisation of existing ambulance bases (refer to Appendix 2)
- Review the sustainable funding levels required for ambulance fleet replacement linked, as appropriate, to the Government Climate Action Plan

Palliative Care Services

Palliative care improves the quality of life of patients and their families facing the challenges associated with life-limiting illness. Specialist palliative care services are provided by the HSE in conjunction with the voluntary sector. Specialist palliative care reduces acute hospital admissions and facilitates earlier discharge from hospitals to the community where care is delivered by the palliative care team in accordance with the needs of the patient and their family.

In 2024, we will:

- Maintain progress in improving access to specialist palliative care in-patient beds for adults
- Advance projects at regional locations, (refer to Appendix 1 & 2)

Rehabilitation Services

The National Clinical Programme for Rehabilitation Medicine describes the framework for the development of specialist rehabilitation services in Ireland, in line with national policy and the strategy for neuro-rehabilitation services. The objective of the Programme is to describe a framework where the ability and societal participation of those affected by complex, life-altering conditions can be maximised by early, timely and life-long intermittent access to specialist rehabilitation.

In 2024, we will:

- Provide capital funding to progress phase 2 of the re-development of the National Rehabilitation Hospital in Dun-Laoghaire

Population Health and Wellbeing

A fundamental goal of developing a sustainable health service is supporting and improving the health of the population. *Sláintecare* recognises the importance of supporting people to look after, and protect their own health and wellbeing and the Joint Action Programmes, position the prevention agenda front and centre. Enabling a number of programmes of work that will assist the services in focusing on promoting and improving health and wellbeing, treatment and care is a continuing priority.

In 2024, we will:

- Provide €2.59m to continue initiatives aimed at improving the health and wellbeing of the population
- Support the continued expansion of BreastCheck Services
- Enable the ongoing fluoridation programme of works in conjunction with Uisce Éireann

CHILDREN'S HEALTH & WOMEN'S HEALTH

Children's Health

Children's Health Ireland, lead the clinical and operational transformation of acute paediatric healthcare. This includes the hospitals at Crumlin, Temple Street and Tallaght and the Urgent Care Centre at Connolly Hospital. The completion and commissioning of the New Children's Hospital on the St. James's hospital campus remains a priority for Government and the HSE. As hydrotherapy is a clinical and therapeutic intervention to support physical health of people with physical and complex disabilities, a national policy for intervention will be developed, including for example, hydrotherapy pools in Special Schools.

In 2024, we will:

- Provide €209.47m towards the completion of the National Children's Hospital
- Support the National Paediatric Hospital Development Board in preparing for the opening of the National Children's Hospital
- Progress the Shared Island, co-funded Daisy Lodge project, a Cancer Fund for Children facility, due to be constructed in Cong, Co Mayo. When completed, Daisy Lodge will provide access to new facilities for children diagnosed with cancer
- Support the delivery of the multi-agency Barnahus model of care

Women's Health

The National Women and Infants Health Programme (NWIHP) was established to lead the implementation of the *National Maternity Strategy – Creating a Better Future Together 2016-2026*, which is focused on strengthening and integrating services. The NWIHP oversees a comprehensive programme of work focused on the health of women and infants and continues to work closely with the DoH to drive forward and implement the *Women's Health Action Plan 2022-2023*.

In 2024, we will:

- Provide €24.54m to continue the construction of the new National Maternity Hospital and other identified projects nationally
- Progress Women's Health Hub projects, including at The Coombe and Tallaght University Hospital
- Complete the tender process for the new National Maternity Hospital on the St. Vincent's University Hospital campus
- Progress the Assisted Human Reproduction Facility at the Lee Centre, Cork
- Progress a number of regional maternity service projects, (refer to Appendix 1 & 2)

ENABLERS

Medical Equipment

The HSE commissioned review and subsequent report entitled *Equipment Replacement Programme, 2016*, concluded that a sustainable level of investment was required annually to replace older and less reliable equipment and address the existing deficit. From a risk and patient safety perspective, a level of funding allocation of €65m per annum is considered critical. A substantial portion of this investment will fund the replacement of existing diagnostic equipment.

In 2024, we will:

- Provide €65m in funding to replace older, less reliable equipment and invest in additional equipment to mitigate risk and manage patient safety – a key deliverable of the HSE
- Complete the review and evaluation of the sustainable level of funding required for the future Medical Equipment Replacement Programme, building on the significant analysis undertaken in 2016

Infrastructural Risk

Management of infrastructural risk is through a combination of minor capital and major capital. Finite capital allocations mean that it is not possible to fund all minor capital requests, increasing the risk profile of existing healthcare infrastructure. The infrastructural risk programme will require sustained investment in future years to mitigate risk. To support the prioritisation and application of funds, a programme of condition surveys on all HSE owned and leased premises was initiated. This programme is nearing completion and will provide a clear, evidence based profile of the entire healthcare estate and comprehensive indicators of the actual cost of upgrading all facilities to 'fit for purpose' standards.

In 2024, we will:

- Provide €72.04m to fund projects which will support the mitigation of risk and the provision of safe facilities for service users, staff and the public
- Continue to prioritise projects central to safety, such as fire safety, electrical safety and emergency supply
- Continue the focus on upgrading life critical systems, including medical gases
- Maintain engagement to address infrastructural aspects of infection prevention and control, including legionella management and ventilation upgrades

Resourcing and Workforce Capability

Having a workforce with the right skills, experience and capacity to support HSE objectives remains a significant enabler for delivery of the Capital Plan. A key objective of the Capital and Estates Strategy is determination of the workforce capability and capacity required to deliver projects in support of healthcare services. This would also reflect regional health structure requirements. Increases in activity, new service approaches and processes, requires timely implementation of capital projects. This is dependent on having a Capital and Estates team with the right skills and experience available. Capital and Estates will remain proactive in efforts to attract, recruit and retain the best talent to ensure high quality delivery of all projects. A request for additional resources to deliver the increasing in value Capital Programme, was included in the 2024 Estimates bid submitted to the Department of Health. Funding for these additional resources is acknowledged through the support of the Department of Health in the Letter of Determination, issued for the HSE National Service Plan 2024.

In 2024, we will:

- Continue to progress the recruitment of resources, key to the delivery of the Capital Plan
- Complete the design of the Capital and Estates Workforce Plan – a key Strategy deliverable

Integrated Workplace Management System

Capital and Estates are aiming to provide an integrated workplace management system, which will enhance service delivery to the HSE, and HSE funded bodies. This digitalisation will; support the standardisation of work processes, improve the efficiency of services, offer real time information and business reporting, ensure consistency and integrity of data and facilitate timely and accurate decision making. Regional health and associated Capital and Estates structures are reflected in this integrated workplace management system.

In 2024, we will:

- Progress key deliverables associated with the implementation of an integrated workplace management system
- Plan the necessary support for developing and introducing building information management (BIM) requirements in all public works management contracts



APPENDICES

Unless stated otherwise, the status of all projects is end Quarter 3, 2023, at time of preparation of Capital Plan 2024



Appendix 1

Projects at Tender Stage, beyond Tender Stage and Contractually Committed in 2024

Funding source is the Department of Health

Hospital Group/CHO Area	Capital Reference No.	Facility	Brief Project Description	Status
Acute Projects				
Children's Health Ireland				
	10001	New Children's Hospital	Development of New Children's Hospital - St James's Hospital Site.	Construction
Dublin Midlands Hospital Group				
	11889	Mount Carmel Hospital	To develop a Surgical Hub facility for Dublin South area to include 4 No. operating theatres (2 major, 2 minor) with support accommodation, including enabling works.	Construction
	13051	Naas General Hospital	To construct modular unit, 12 no. single rooms. This would assist in the isolation of suspected COVID-19 and other infectious organisms' cases (feasibility study underway).	Construction
	11712	Portlaoise MRH	Mechanical Upgrade Works to 10 no. Existing Ventilation Systems incl Theatres 1 & 2; Paed Isolation Rooms A, E; Decontamination Unit.; Endoscopy Procedure Room 1 & 2; Special Care Baby Unit Decontamination Unit, Special Care Baby Unit.	Construction
	13003	Portlaoise MRH	Respiratory Assessment Unit (RAU): Provision of 2-storey modular building ca. 800m2 to provide respiratory assessment unit for ED to segregate Covid & non-Covid clients.	Construction
	11713	St. James's	Reconfiguration of existing cardiology accommodation to provide space for a third cath lab. Equipping costs included.	Construction
	13058	St. James's	Three storey extension to the ground floor OPD @ SJH. This project is to facilitate urgent facilities for NON INVASIVE CARDIOLOGY DIAGNOSTIC and RESPIRATORY services central to the hospital due to the COVID-19 restrictions of space in the existing location.	Complete 2022
	11488	Tallaght University Hospital	Provision of a replacement Pharmacy Aseptic Compounding Unit	Construction
	11862	Tallaght University Hospital	Replacement of 13 existing lifts on campus over a three year period - mixture of patient/goods lifts and visitor lifts.	Construction
	11458	The Coombe Hospital	New Interim Laboratory - National Cancer Screening Service (excludes equipping) See Cap Ref # 1458a for off-site works on HSE Lands	Construction
Ireland East Hospital Group				
	11760	Mater Hospital	Emergency Department extension of 450sqm to allow patient streaming including the separation of Covid positive and other infectious patients. The extension will consist of triage, resus, treatment cubicles and support spaces. The proposed extension will replace the existing tent structure used for COVID streaming.	Construction
	13031	Mater Hospital	Construction of 112 bed Ward Block (96 No. single isolation rooms, each capable of ventilation and high-flow oxygen delivery, & 16 No. Intensive Care Beds)	Construction
	11585A	Mater Hospital	Mater Major Trauma Centre - Phase 1B consists of 2 Nr Theatres; An additional CT and a New MRI. It will also contain ancillary and support space and some shell & core space.	Tender
	13031a	Mater Hospital	National Isolation Unit made up of 2 No. Highly Infectious Disease Containment Suites.	Construction
	11859	Swords Business Park	To develop a Surgical Hub facility for Dublin North area to include 4 No. operating theatres with recovery or post anaesthetic unit (including an 9-bed primary recovery unit and a further 16 beds in a second stage recover). The development shall also include an admission suite and support services and staff facilities.	Construction
	11273	Mullingar MRH	Extension to Radiology Department to accommodate an MRI being provided by others	Construction
	13005	Mullingar MRH	New Projects: OPD department to accommodate a Respiratory Assessment Unit (RAU) Adult & Paediatric.	Construction
	11829	NMH Holles Street	1. Replacement of below ground Low Voltage cables feeding the NMH due to age, fatigue and increased overall load. 2. Install Emergency Generator 'Tie In Points' – required due to the single Primary Electrical Supply, Transformer and Switch arrangements. 3. Replacement of one of the existing generator with a new 1500kVA unit 4. Incorporate an electrical load shedding strategy of non-essential services (58-61 MSH) in combination with Phase Failure Relays for other loads such as the Autoclaves & Washers. 5. The rebalancing of the electrical loads equally throughout the hospital across 3 phases.	Construction
	10908	NMH to SVUH	Relocation of National Maternity Hospital, Holles Street to the St. Vincent's University Hospital Campus.	Tender
	11646	NRH Rochestown Avenue	Proposed relocation of the existing pharmacy to provide increased pharmacy space and place it more centrally to the new building. Works also consist of the refurbishment of an existing vacant ward (7 bed ward in Cedars Building) to provide a doctors residence.	Construction
	11632	Our Lady's Hospital, Navan	Removal of old pre fab structures and construction of an extension to the rear of the OPD OLH Navan (75 sqm) - Rheumatology. Extension will house 4 No. consulting rooms, 3 No. WC's, 1 No. Training Room	Construction
	11022C	Our Lady's Hospital, Navan	Upgrade of the existing mortuary at Our Lady's Hospital, Navan. Upgrades will include the PM room, office, toilets, viewing room split into large and small rooms, external works at entrance including parking, as well as heating, lighting and power. New facilities include family room, staff changing, stores, meeting room, an additional fridge as well as specific ventilation for PM room.	Construction
	11715	RV Eye & Ear Hosp	Proposed relocation of the existing Audiology Dept. to another location (71sqm in old file room, basement East Wing) within the RVEEH to provide increased acoustic separation. Project also includes for additional equipment. Project to include two testing booths, reception area, office space.	Construction
	11363	St. Luke's Hospital, Kilkenny	New 72 Bed Replacement Medical Ward Block	Complete 2022
	11648	St. Luke's Hospital, Kilkenny	Phase 4 Electrical Infrastructure Upgrade works: To upgrade the electrical infrastructure to address significant single points of failure resulting in power failure to critical clinical care areas and wards. To improve redundancy and resilience.	Construction
	11736	St. Luke's Hospital, Kilkenny	Replacement of existing CT scanner (2009) with new. Equipment cost in ERP.	Construction



Appendix 1

Projects at Tender Stage, beyond Tender Stage and Contractually Committed in 2024

Funding source is the Department of Health

Hospital Group/CHO Area	Capital Reference No.	Facility	Brief Project Description	Status
	11839	St. Luke's Hospital, Kilkenny	Surgical 2 ward (29 beds) is vacant and will be refurbished to accommodate beds transferred from Surgical 1 ward. Surgical 1 ward will then be refurbished to accommodate 14 beds. Medical 1 ward is vacant and will be refurbished to accommodate 14 beds from Medical 2 ward (currently 29 beds) along with space for a Paediatric day unit.	Construction
	11301	St. Vincent's University Hospital	Develop a 6 bed Critical care unit by refurbishing St Patricks Ward on the fourth floor of Block H. The new ICU ward will have direct connectivity to the existing ICU in Block N on the same Floor level which will allow for shared schedule of accommodation.	Tender
	11540	St. Vincent's University Hospital	Fire safety Upgrade Works - Fire Alarm & compartmentation	Tender
	11614	St. Vincent's University Hospital	Fire safety Upgrade Works - Passive Fire Safety Works (Fire Doors, Compartmentation, phased etc.)	Construction
	11649	St. Vincent's University Hospital	Day Oncology Unit. Reconfiguration of day ward (350sqm - St Anne's Day Ward) to increase the number of treatment spaces by 9 no. to a total of 28 no.	Tender
	11716	St. Vincent's University Hospital	The project involves the building of a new electrical substation (Energy Centre) at Block S that will serve Blocks H, P & S of St. Vincent's University Campus. The new energy centre will consist of 2 x transformers backed up by 2 x standby generators in order to provide N+1 redundancy for the electrical infrastructure	Tender
	11781	Wexford General Hospital	Increase CSSD capacity by providing 2 additional washers and dryers, improve zoning for clean / dirty segregation and process flow, provide new AHU for HTM compliant ventilation and RO plant .	Tender
	11800	Wexford General Hospital	Fire damage restoration works	Construction
	11737	Wexford General Hospital (Ely Hospital)	Renovate and improve the existing Endoscopy service and old Theatre space at Ely Hospital to include 2 fully compliant endoscopy rooms and a minor procedures room.	Construction
RCSI Hospital Group				
	11336	Beaumont	20 bed purpose built Cystic Fibrosis in patient facility.	Construction
	11541	Beaumont	Infection control works - Refurbish fabric and fittings of Sanitary Facilities on a rolling program, over a 5 year period	Construction
	11542	Beaumont	Fire Alarm & Emergency Lighting Upgrade & Compartmentation	Construction
	11249B	Beaumont	Refurbishment of Rockfield House (65 spaces), St. Anne's (38 spaces) and Beaumont House (85 spaces) for use as admin accommodation.	Tender
	13065	Cavan General Hospital	Extend OPD into Lisdam Community Care building to provide an interim project. In addition ground floor to be used as interim ECC Hub.	Construction
	11402	Connolly Hospital Blanchardstown	Integrated Pathology Lab (includes Biochemistry, Microbiology, Haematology, Blood Transfusion unit & Histopathology. To be developed as part of RCSI Project (Graduate Programme)	Construction
	11620	Rotunda	Purchase and fit out of building (Earl Building, Cleary's Quarter) for clinical ambulatory services who will relocate from their current Rotunda location in order to provide the necessary free space for this new Wing. See Project Ref 11338.	Construction
	11625	Rotunda	Upgrade of the Emergency Lighting System and the Fire Detection Alarm System.	Construction
Saolta University Hospital Group				
	11393	Letterkenny University Hospital	Fire Safety Upgrade - Fire Alarm upgrade & new Emergency lighting system.	Construction
	11587	Letterkenny University Hospital	Extension to Laboratory (Microbiology, Virology and Immunology) to provide capacity for Additional Covid 19 Testing (additional equipment and staff already in place) and to bring the Lab up to current standards (not upgraded post flooding event).	Construction
	11600	Letterkenny University Hospital	Accommodation for Physio and OT dept at LUH (420sqm). This accommodation is to reinstate accommodation dispersed due to flooding at LUH.	Tender
	11283	Mayo University Hospital	Electrical Upgrade, Phase 1. Phase 1a & 1b (complete 2022), 1c at construction. New submission to follow for Phases 2 & 3	Construction
	11423	Mayo University Hospital	HSSD Reconfiguration & Upgrade (including feasibility study), Equipment from ERP	Construction
	11719	Mayo University Hospital	Building works associated with the replacement of the existing CT Scanner. Proposed works include the construction of an extension to house the new CT Scanner. Equipment costs in ERP.	Construction
	11588	Merlin Park University Hospital	Development of a Cystic Fibrosis Unit in Merlin Park University Hospital will accommodate an Adult Cystic Fibrosis Outpatient Services and five day service . It is proposed that a new building will be provided on a site opposite Unit 8 (respiratory OPD & day unit). may be delivered in parallel with Phase 1 OPD See Cap Ref # 1143b for adjacent project.	Construction
	11809	Merlin Park University Hospital	New MV sub-station and associated electrical works at MPUH required to support ongoing and new Capital Projects at MPUH.	Construction
	10674a	Merlin Park University Hospital	Day surgery unit (4 Theatres, CSSD, 2 endoscopy suites, day ward upgrade) - Proposed Surgical Hub	Tender
	11143B	Merlin Park University Hospital	The proposed project is a Ground & First floor Outpatients Department in MPUH (50 consulting rooms) to accommodate the outpatient services which are discommoded by the proposed new Emergency Department & Womens & Childrens project at UHG, and to provide capacity for outpatient services.	Construction
	11132	Portiuncula University Hospital	New replacement Ward Block (50 Beds) to provide replacement ward accommodation in line with current standards.	Construction
	11448	Portiuncula University Hospital	Fire upgrade - Phase 1: Fire detection and alarm network complete and Phase 2: FA & emergency lighting medical block	Construction
	11589	Portiuncula University Hospital	Project involves the creation of 8 No. single en-suite rooms & 2 No. two bedded en-suite rooms (12 beds total) in the existing OPD Dept. The existing OPD will be vacant in March 2021 following the installation of some prefabricated accommodation on-site.	Complete 2023
	10781	Sligo University Hospital	CSSD Upgrade (stalled due to Covid), temporary works in 2022, phased delivery. P1 wash area, P2 dry/packing area.	Construction
	11429	Sligo University Hospital	Additional Bed Capacity: Provision of a 2 x 21 bed wards, single en suite rooms with ancillary accommodation. PP & Fire Cert granted. Enabling Works under #11429a (car park). To proceed to construction.	Tender



Appendix 1

Projects at Tender Stage, beyond Tender Stage and Contractually Committed in 2024

Funding source is the Department of Health

Hospital Group/CHO Area	Capital Reference No.	Facility	Brief Project Description	Status
	11429A	Sligo University Hospital	Carpark and associated enabling works to facilitate the provision of a new Ward Block. See # 11429.	Construction
	11351	University Hospital Galway	Medium Temp Hot Water System upgrade/replacement Phased development.	Construction
	11434	University Hospital Galway	Third Endoscopy suite	Construction
	11512	University Hospital Galway	Research Hybrid Cardiac Cath Lab - co-funded with SFI & NUI Galway. Phase 1 - procurement & installation of a CT on GF of CRF building (complete). Phase 2 - Development of Hybrid Cardiac Cath Lab adjacent to existing two Cath Labs. Phase 1 (CT)	Construction
	11529	University Hospital Galway	Sexual Assault Treatment Unit. Relocation to a leased facility. Co-funded with TUSLA & Justice	Complete 2021
	11616	University Hospital Galway	Relocation of the Public Health Microbiology Laboratory (PHML) to a new building to increase capacity of the PHML and the Dept of Medical Microbiology generally. Existing PHML space to be used for expanded COVID testing capacity - Interim solution	Construction
	11309A	University Hospital Galway	Cardio Thoracic ward: Phase 2 - provision of a Cardiac Thoracic Ward (12 beds)	Complete 2022
South South West Hospital Group				
	11412	Bantry General Hospital	Endoscopy Suite (Single DT for 11412 & 11413). Enabling works complete - MV LV upgrade	Construction
	11413	Bantry General Hospital	Stroke Rehabilitation Unit - 12 Bed (Single DT for 11412 & 11413) Planning granted	Tender
	11144	CUH	Provision of a new Helipad - Major Trauma (including 300 space 2 storey carpark - Phase 1 & other enabling works, demolition, link corridor, lifts & O2 tank relocation)	Construction
	11533	CUH	CUH Teaching & Academic Centre - HSE contribution to construction of one floor of UCC Medical Teaching & Academic Centre at CUH (shell space only). HSE will own one floor (circa 800m2) of the three storey development. Fit out cost will be subject to a separate submission.	Tender
	11611	CUH	Replacement of cladding, CRC (Cardiac Renal Centre) building	Construction
	11783	CUH	New CT scanner housed with control room, contiguous with two trauma bays, family rooms, a decontamination room, etc. to be able to offer a resuscitation facility for major trauma centre designation / reception.	Tender
	11794	CUH	Purchase and fit out of existing building (UTC 4, Curraheen, Cork) for use as an Out-patient Department. Project will support the development of clinical facilities at CUH.	Tender
	11971	CUH	Purchase of property (13 Wilton Road) adjacent to CUH so support future development of the hospital.	Tender
	10532C	CUH	CUH Projects Enabling works (Ring Road, Services, etc.), Paeds Cap Ref 532a is dependent on this project. Construction Management Team being engaged.	Tender
	11897	CUH	Day surgery unit (4 Theatres, CSSD, 2 endoscopy suites, day ward upgrade) - Proposed Surgical Hub	Tender
	11480	CUMH	Supply and Installation of Mechanical Air Conditioning to the Cork University Maternity Hospital	Construction
	11970	Mallow General Hospital	Purchase of property adjacent to Mallow General Hospital so support future development of the hospital.	Tender
	13012	Mallow General Hospital	Replacement Medical Ward: As Phase 1, replace the existing sub standard medical ward accommodation with 48 new single bedrooms in 2 wards to modern day (HBN) standards. Includes two floors as shell and core.	Construction
	11721	Mercy University Hospital	Electrical Infrastructure upgrade works based on the output/recommendations from various condition surveys.	Construction
	11036B	SIVUH	Refurb/upgrade of 2 theatres & accommodation to facilitate relocation of Ophthalmic Surgery from CUH	Complete 2022
	13013A	Tipperary University Hospital	Works to refurbish existing accommodation to modern standards to provide 33 beds (6 no singles & 9 no 3 beds) including link corridor	Construction
	11190	University Hospital Kerry	Blood Science Project - Vertical extension & Refurbishment of existing pathology laboratory to facilitate management services tender	Construction
	11463	University Hospital Kerry	UHK Water Infrastructure Replacement	Construction
	11268A	University Hospital Kerry	Provision of an additional Theatre (Obstetrics) (vertical extension) plus upgrade of existing theatres and plant.	Tender
	11548	University Hospital Waterford	MRI Replacement and associated Fire / Infrastructure Upgrade Works (Equipment purchase in ERP).	Construction
	11892	University Hospital Waterford	To develop a Surgical Hub facility for Waterford. Surgical hub to provide 2 no. Day Surgery theatres and 2 no. Minor procedure rooms along with recovery or post-anaesthetic facilities. The development will also include an admission suite, support services and staff facilities.	Tender



Appendix 1

Projects at Tender Stage, beyond Tender Stage and Contractually Committed in 2024

Funding source is the Department of Health

Hospital Group/CHO Area	Capital Reference No.	Facility	Brief Project Description	Status
University of Limerick Hospital Group				
	11320	Croom Orthopaedic Hospital	Fire Upgrade Works, Passive works - Phased	Construction
	11537B	Croom Orthopaedic Hospital	Refurbishment of St Anne's Day Ward and associated works. Works being funded through a charitable contribution for redevelopment of Croom Orthopaedic Hospital.	Complete 2022
	11417	Ennis General Hospital	Equipping of new OPD, including provision of X-Ray Room and other diagnostics.	Complete 2021
	11790	Raheen, Limerick, Houston Hall	Fit out of office accommodation for use by Medical Records, HIPE, Quality & Risk, Finance etc.	Construction
	11113	University Hospital Limerick	Ward Block Replacement (4x24 beds). Located over ED and Renal Dialysis Units.	Construction
	11244	University Hospital Limerick	The provision of a new Blood Science & Pathology facility. Phased (5 phases) development. Phase 1 complete, Phase 2 complete Oct 21. Interim Facility in 2017. Phase 3 - fit out of existing histology labs (2023) UHL	Construction
	13035	University Hospital Limerick	Construction of a new modular COVID Lab at UHL to manage testing. The equipment and the team are currently housed in the CERC building which needs to return to education.	Complete 2021
	11861	University Hospital Limerick	To develop a Surgical Hub facility for Limerick. Surgical hub to provide 2 no. Day Surgery theatres and 2 no. Minor procedure rooms along with recovery or post-anaesthetic facilities. The development will also include an admission suite, support services and staff facilities.	Tender
	11113a	University Hospital Limerick	Construction of phase one of the second intended hospital block as per the site masterplan including basement car parking (160 spaces) and shell space at level 0 and level 1 as an extension of the current construction works. The scale of the development envisaged is approximately 11,400 sqm over four floors.	Construction
	11496	University Maternity Hospital Limerick	Neo-natal expansion, Phase 1 - relocate clinical staff to modular, complete 2021. Phase 2 - 2022 Neo natal spaces to follow	Construction
National				
	11022	Design & Dignity Scheme	The Design & Dignity Grant Scheme provides funding for minor works in Acute hospital and community care environments that will enhance end of life care. This scheme is co-funded (30%) by the Hospice Friendly Hospitals Programme.	Construction
	11560	Covid-19 Medical Gases Resilience Project	Essential works required to address deficits in the provision of Medical Gas in a phased basis, highlighted by Covid-19.	Tender



Appendix 1

Projects at Tender Stage, beyond Tender Stage and Contractually Committed in 2024

Funding source is the Department of Health

Hospital Group/CHO Area	Capital Reference No.	Facility	Brief Project Description	Status
Radiation Oncology				
Dublin Midlands Saolta University Health Care Group	11503	St. Luke's Hospital, Rathgar	New Fire Detection & Alarm System plus passive fire safety works.	Construction
	10008G	University Hospital Galway	Main contract works for the provision of Phase 2 facilities at UCH Galway.	Complete 2023
Ambulance				
CHO 5	11636	New Ross	Purchase of building (former Fire Station) at New Ross, Co. Wexford for new Ambulance Base (includes site purchase WCC, title issues).	Construction
National		National	Ambulance Replacement Programme.	Tender
Community Care (Disability - Shared Projects)				
CHO 2	11037	Tuam	Provision of a Community MH Team base, OPD facilities & Day Hospital. Teams, etc. Phase 2 will provide accommodation for Disability Services, Early Intervention Services, School Age Teams, etc. This is a combined project - Mental Health & Disability Services (#11037).	Complete 2023
Enhanced Community Care				
CHO 2	13202	HUB 04 - Galway City, St. Francis Home	Refurbishment of HSE building (St Francis Home, Newcastle, Galway) to provide clinical space for interim ECC Hub.	Construction
CHO 2	13203	HUB 05 - Ballinasloe	Refurbishment of 1st Floor of Eastern Wing (Our Lady's Ward), St. Brigid's, Ballinasloe. Area is 650sqm.	Complete 2023
CHO 3	13237	HUB 08 - Ennis PCC	Equipping of an extension of Ennis PCC to accommodate ECC Hub.	Equipping & Commissioning
CHO 3	13218	HUB 08 - Nenagh	Equipping of an extension to Nenagh PCC to accommodate ECC Hub.	Tender
CHO 5	13236	Hub 14 - Waterford	New CHN storage unit (Dungarvan).	Complete 2023
CHO 5	13219	HUB 13 - Kilkenny	Equipping of new building adjacent to existing Kilkenny City East, New Park PCC (extension of lease terms) to accommodate ECC Hub.	Tender
CHO 7	13212	HUB 20 - Cherry Orchard	Phase 1, Refurbishment of Unit 3 (Blackthorn) at Cherry Orchard to accommodate ICPOP. Works include decant of a service currently operating out of Unit 3, (Education and Training Service) to a modular building (200sqm). Phase 2, Extension at Blackthorn 200m2 modular.	Construction
CHO 7	13210	HUB 19 - Our Lady's Hospice, Harolds Cross	Fit out of leased space (approx. 230sqm) at Our Lady's Hospice, Harolds Cross Campus to accommodate an interim ICPOP team.	Tender
CHO 7	13226	HUB 21 - Russell Centre	Equipping of an extension to the Russell Centre PCC to accommodate ECC Hub & diagnostics.	Tender
CHO 9	13248	HUB - 28, Beaumont - Omni Shopping Centre, Santry	Upgrade works of leased building to achieve A3 compliance, equipping of 1st and 2nd floor Omni Shopping Centre for ECC ICPOP, ICPCDM and Larkhill PCT	Tender
Health & Wellbeing				
National	11127	National Fluoridation Programme	Replacement of fluoridation systems in Local Authority Water Treatment Systems.	Construction



Appendix 1

Projects at Tender Stage, beyond Tender Stage and Contractually Committed in 2024

Funding source is the Department of Health

Hospital Group/CHO Area	Capital Reference No.	Facility	Brief Project Description	Status
Mental Health				
CHO 2	11037	Tuam	Provision of a Community MH Team base, OPD facilities & Day Hospital. Teams, etc. Phase 2 will provide accommodation for Disability Services, Early Intervention Services, School Age Teams, etc. This is a combined project - Mental Health & Disability Services (#11037).	Complete 2023
CHO 2	10008B	University Hospital Galway	Provision of a replacement Acute MH Unit to facilitate the development of a Radiation Oncology Facility on the campus	Complete
CHO 2	10085A	St. Anne's Child & Adolescent Psychiatry	Extension & reconfiguration, commenced under MH Revenue, planning granted	Construction
CHO 4	11733	Carraig Mór Centre, Shanakiel	Phase 1: Reconfiguration and extension of Carraig Mór to provide 18 no single bedrooms (replacement) with en-suites and additional communal floor space for residents & support accommodation.	Construction
CHO 4	11798	Middleton	Purchase of property at 37 Lauriston, The Park, Middleton for use by Mental Health Services as an independent living unit.	Construction
CHO 5	11286	St. Canice's Hospital, Kilkenny	Accommodation for Community CAMHS accommodation, refurb	Tender
CHO 5	11374	Dungarvan	Purchase and replacement of dwelling at Sea Breeze, Youghal Rd, Dungarvan. Replacement accommodation (new build) for 11 (check) residents of Springmount at Dungarvan Community Hospital (Agreed with MH Commission)	Construction
CHO 6	11487	Mount Carmel Campus	The provision of accommodation in the vacant convent for an Eating Disorder Specialist Hub to provide services for CHO6. Includes fit out of 215 sqm CAMHS, new submission approved Jan 22.	Construction
CHO 8	11574	Portlaoise MRH	AMHU anti ligature works, phased delivery	Construction
CHO 9	11949	101 - 102 Malahide Road	Purchase & refurb of existing building (101 - 102 Malahide Road) currently leased by the HSE to accommodate CAMHS.	Tender
CHO 9	10939A	Grangegorman - Dublin North Inner City	Relocation of Eve Holdings to 1-5 Grangegorman Villas to facilitate development of Grangegorman PCC.	Construction
Community Care (Capacity & Other)				
CHO 1	11631	Letterkenny	St. Conal's Refurbishment - fabric upgrade of Block R	Construction
CHO 4	13039	St. Finbarr's Hospital	St Finbarr's Older Person Replacement Rehab Beds (St Clare's and St Oliver's) (20 replacement single room beds in new build and refurbish 50 beds in existing).	Complete 2022
CHO 6	11596	Donnybrook, Royal Hospital	This project will: 1) Convert the vacant Phoenix Ward to create 4no. Single rooms and 2no. Double rooms i.e. 8 No beds to replace 8 No. beds to be lost on the Oaks and Cedar Wards and the 1 No. single room each on the Oaks and Cedar wards to be held vacant for end of life/Covid isolation. 2) Convert and refurbish 4no. rooms in Oaks ward and 4no. Rooms in Cedar ward to reduce 5 bed wards to 4 bed wards (i.e. 8 beds lost) 3) Refurbish 1no. existing four bedded room in Oaks ward and Cedar ward (i.e. 2 No rooms total).	Construction
CHO 6	11723	Leopardstown Park Hospital	Reconfiguration of 4 x Nightingale Wards (978sqm) in order to sub-divide each ward into 2 x 4-bed rooms and 2 x 1-bed rooms as per SI 293/2016 (Hiba condition). The project will include a rewire of electrical services, upgrade of heating system, upgrade of fire compartmentation to suit the revised layout, new suspended grid ceiling and decoration of all 4 x nightingale wards.	Construction
CHO 6	11724	Leopardstown Park Hospital	Replace the main electrical distribution board (DB2) serving the campus along with the existing sub distribution boards fed from DB2. The sub mains cables will also be upgraded.	Construction
CHO 7	11258	Monasterevin	Drogheda St Monasterevin To renovate an existing building (dispensary) to provide accommodation for an Older Person Day services unit and PCC services.	Construction
CHO 7	11340	Castle Street Clinic, 37 - 41 Castle Street, Dublin 2	To upgrade existing building to acceptable standard to continue to deliver alcohol and drugs specialist services as part of health & Social care network for 244 service users. Phased project	Construction
CHO 7	11597	Cherry Orchard	Fire safety and Infection Control Risk project in Aspen, Hazel, Popular & Beech units to address Fire Safety issues in existing elderly care units, including Dementia units. Addresses also other priority works whilst the units are vacated, including elements of rewiring and infection control / staff welfare considerations.	Construction
CHO 7	13018	Peamount Hospital, Newcastle	Reconfiguration of an existing 18-bed High Dependency unit (Hollybank) for older Intellectual Disability Clients. Works necessary to meet Covid Social Distancing and are also stipulated necessary by HIQA to gain re-registration. Unit will be reconfigured from multi-occupancy to 11x1-bed + 2x2-bed units + necessary social distancing break-out space for 15 clients.	Complete 2022
CHO 7	11532	Cherry Orchard	Structural repairs to sub floor in en-suites and circulation corridors in Willow & Sycamore units and address identified Fire Risk Works in existing Willow & Sycamore units	Tender
CHO 7	11629	St. Vincent's Athy	Renovation of an existing vacant nightingale ward to convert it to a Day Care Centre. Existing Day Care Centre will relocated to the refurbished area.	Tender
CHO 8	11812	Various	Completion of fire upgrade works (fire door upgrades, compartmentation/ sub-compartmentation, fire stopping, upgrades of ceilings) to 6 no. midlands CNU's following completion of Fire Risk Assessments. (Mountmellick CNU, Mountmellick; Abbeyleix CNU, Abbeyleix; Shaen Hospital, Portlaoise; Riadha House CNU, Tullamore; Offalia House CNU, Edenderry; Cluin Lir, Mullingar).	Tender



Appendix 1

Projects at Tender Stage, beyond Tender Stage and Contractually Committed in 2024

Funding source is the Department of Health

Hospital Group/CHO Area	Capital Reference No.	Facility	Brief Project Description	Status
Primary Care				
CHO 1	10143	Monaghan Town	Primary Care Centre to be developed on HSE owned site (St Davnet's). Includes a MH PC Centre. (National Ranking 28)	Complete 2023
CHO 1	10538	North Sligo	North Sligo Network PCC (Grange, Drumcliffe). (75) Two site solution.	Complete 2023
CHO 1	10910	Sligo University Hospital	North West Hospice extension to provide 12 beds (4 additional), outpatient day care & home care team, admin space, 15 car park spaces	Construction
CHO 3	11172	Ennis	The provision of a fit-for- purpose residential addiction treatment service to replace the existing facilities in Bushy Park, County Clare.	Construction
CHO 5	11481	St. Otterans	Development of Audiology Services & new Orthodontic development at rear Block, Ground floor of vacant St Otterans building. Enabling Works progressed 2021. 1481 & 1482 Combined to one project.	Construction
CHO 8	11519	Castlebellingham	Refurbish, reconfigure & extend existing HC to create a PCC (National Ranking 228)	Complete 2023
CHO 9	10939	Grangegorman - Dublin North Inner City	Primary Care Centre(12) to be developed on site in Grangegorman (includes Audiology).	Complete
CHO 9	11469	Kilbarrack Primary Care Centre	Refurbishment, reconfiguration & extension of Kilbarrack Primary Care Centre on existing PCC site	Construction
National	10753	Primary Care Centres	Implementation of Strategy - PM, Telephony and Equipping Costs	Equipping & Commissioning
National		National	The provision of Primary Care Centres by means of Public Private Partnership's.	Operational

Community Care (HIQA) Older Persons				
CHO1	10091	Letterkenny	110 Bed CNU & Medical Rehab to replace existing beds and address capacity deficit as per Service Priority List (formerly PPP).	Construction
CHO1	11660	Falcarragh CNU	Refurbishment (HIQA agreement to follow Dungloe) - 35 beds	Construction
CHO1	11179	Ballyshannon	80 Bed CNU to replace existing beds at the Sheil & the Rock as per Service Priority List.	Complete 2023
CHO1	10030	Carrick On Shannon	The Project will provide a Community Nursing Unit of 90 beds on a new site.	Tender
CHO2	11387	Merlin Park, Units 5 & 6 (includes inflation)	New 60 bed Replacement Unit (formerly PPP) (25 No beds x 2 wards and 10 No. dementia beds).	Construction
CHO2	11709	Tuam Community Nursing Unit	New 50 bed Replacement Community Nursing Unit	Complete 2023
CHO3	10135	St Camillus, Limerick	Phase 1, 75 Bed CNU to replace long stay beds in St Camillus in two phases as per Social Care Priority list	Construction
CHO3	10902	St. Ita's, Newcastle West	Refurbishment & 12 additional bed extension - 66 beds	Construction
CHO3	11426	St Conlon's CNU, Nenagh	New Replacement (50 bed)	Construction
CHO4	10231	Kanturk	Kanturk Community Hospital Extension & Refurbishment - 33 beds	Construction
CHO4	11684	St Patrick's CH Fermoy	HIQA Compliance - Refurbishment & Extension - 71 beds	Construction
CHO4	11687	St Joseph's CH, Millstreet	HIQA Compliance - Refurbishment & Extension - 22 beds	Construction
CHO4	11689	Macroom CH	HIQA Compliance - Refurbishment & Extension - 38 beds.	Construction
CHO4	11681	HIQA - Kinsale	HIQA Compliance - Refurbishment & Extension - 40 beds	Complete 2023
CHO4	11973	Middleton Community Hospital	Emergency works following flood 18th October, 2023	Construction
CHO8	11702	HIQA - St Vincent's Mountmellick	HIQA Compliance, Phase 1, 50 bed new build	Construction
CHO8	11705	St Mary's Hospital, Drogheda	Combine Boyneview & St Mary's, Refurbishment & Newbuild 60 Beds	Complete 2023
CHO8	11706	St Joseph's Care Centre, Longford	HIQA Compliance - New build 43 beds including 2 palliative care beds (68 beds in total on site, remainder stay as is)	Tender
National	11259A	CNUs Replacement	The provision of replacement CNUs by means of PPP(s) as part of the Government's Capital Review announced by the Minister of Performance, Expenditure & Reform on 29th Sept 2015 - Enabling Works & VAT	Tender
National	11259B	CNUs Replacement	The provision of replacement CNUs by means of PPP(s) as part of the Government's Capital Review announced by the Minister of Performance, Expenditure & Reform on 29th Sept 2015 . Unitary Charge.	Tender



Appendix 2

New Projects and Projects to Progress Through Design

Funding source is the Department of Health

Hospital Group/CHO Area	Capital Reference No.	Facility	Brief Project Description	Status
Acute Projects				
Children's Health Ireland				
Dublin Midlands Hospital Group				
	11754	MRH Tullamore	New single story extension to the existing Emergency Department at MRHT. - 8 consulting rooms (Private Consultant Suites being relocated for Hospice Development) - 10 bed AMAU (1 No. 5 bay ward, 1 No. 4 bay ward, 1 No. Single room) - Expansion and reconfiguration of existing ED to provide additional triage spaces and waiting areas and offices	Appraisal
	11825	MRH Tullamore	Oncology Day Ward extension via a proposed 2 storey vertical extension (700sqm) above Medical 1 Department to provide: Level 1 - 8 No. new ward isolation rooms Level 2 - 3 No. consulting rooms, 8 bay treatment area, 1 No. isolation room and associated services	Appraisal
	11777	Naas General Hospital	Reconfiguration and refurbishment of existing space to provide 11 bedded AMAU (300sqm). In addition an ED admissions and discharge lounge will be created.	Detailed Design
	11900	Naas General Hospital	15 cubicle transition unit for patient admissions and discharges, to alleviate ED admission pressure, via refurbishment of an existing area in OPD.	Appraisal
	11901	Naas General Hospital	Replacement of MRI including enabling works, decommissioning of existing and commissioning of new. Equipping cost included in ERP.	Appraisal
	11903	Naas General Hospital	Upgrade/replacement works to passive and active fire safety protection features throughout the hospital campus including additional means of escape from specific areas (Liffey Wards). Regularisation Fire Safety Certificate.	Appraisal
	11022E	Naas General Hospital	This project involves the development of a suitable new mortuary (350sqm) at the Naas General Hospital. The development will include for a chapel of rest, family room, counselling room, PM room, bereavement office, and associated rooms.	Appraisal
	11729	Portlaoise MRH	Project to complete works based on fire safety audit report. Works include Fire rating of walls, partitions and compartmentation, Fire doors replacement and upgrading Means of escape door fastening upgrades, AOV installations in stairwells, Fire detection and alarm systems upgrade and Emergency lighting system upgrade and recommissioning.	Detailed Design
	11445	St. James's	Existing Burns Unit consist of 14 beds (8 single and 1 No. six bedded). Proposal is to reduce existing 14 beds to 10 single rooms. This will include providing 2 new critical care spec. isolation bedrooms. Works also include reconfiguration of the interview room, day room and OT facility. Works include a new extension and refurbishment of the existing and also decanting of the existing ward to complete the works.	Detailed Design
	11726	St. James's	Provision of an eight storey Critical Care ICU (increased capacity) and replacement Burns Unit. 114 beds, 43,140sqm in total. Unit will include 64 ICU beds (30 additional, 34 replacement), 11 Coronary Care beds (2 additional, 9 replacement), 6 hyper acute stroke beds (0 additional, 6 replacement), 3 HDU beds (0 additional, 3 replacement), 15 contingency beds (15 additional, 0 replacement), six theatres, 15 Burns Unit HDU beds (0 additional, 15 replacement) and two burns theatres. Project also includes Phase 1 of a new ED (32 single rooms & 8 resus) and education & training space. Project also includes a new 40 bed ward block for decant and a new OPD at Davitt Road, so as to create a site at St James's Hospital.	Design Feasibility
	11827	St. James's	Proposed biobank with physical biobank and biocomputing infrastructure for medical research. 4 storey building, 1,190sq.m as an extension to St. James's Hospital Mortuary.	Appraisal
	11828	St. James's	Cancer Care - Phase 1 project to provide a Multi-storey facility with 150 single inpatient rooms for medical oncology, and malignant haematology patients; 20 patient consultation/ examination rooms; 50 haematology oncology day treatment rooms; 6 minor procedure rooms and 6 operating theatres. Radiation Oncology (PH II) to be included in Phase 2 of this project.	Appraisal
	11904	St. James's	Campus Electrical upgrade: Phase 1: Replacement of two existing transformers & LV Distribution board in the Energy Centre. Installation of LV Substation metering. Phase 2: Increase backup capacity to N+1 by installing one new 2MV backup generator (brings overall number to 3Nr generators. Replacement of two MV ring main units.	Appraisal
	11905	St. James's	Reconfiguration of existing ultrasound department to provide 2 No. additional procedure rooms, 1 No. additional scanning room and 5 No. space recovery day ward.	Appraisal
	11906	St. James's	Expansion (phased) of the existing Haematology/Oncology Day Centre into a vacant adjacent space. Project will increase consulting rooms from 11 to 25, oncology treatment couches from 18 to 31 oncology and 12 haematology, apheresis treatment bays from 2 to 5, isolation rooms from 3 to 5.	Appraisal
	11931	St. James's	New Integrated Urgent Care/Diagnostic Centre is as follows located on HSE & St. James Hospital site at 162-165 James Street. Centre will include clearance of existing site, new build consisting of an circa 8,000sq.m across 5 stories including Basement Car parking, Diagnostic Services(3No.X-Ray, 3No. MRI & 1No. CT), Cafe/Retail, 48No. Consulting suites (16No Consulting suites per floor), Multipurpose Rooms, Support & Ancillary Spaces	Appraisal
	11932	St. James's	DCP for Davitt Road Campus (100,000sqm) and SAR/PBC for proposed Phase 1 & 2. Phase 1: Outpatients and Diagnostic Facilities Decant SJH Outpatient Activity; 14,000sq.m, 3 MRI, 3 CT Scan, 6 Ultrasound, 3 x-ray etc. Phase 2: Acute Health Inpatient Unit 38-50 beds + green spaces; total 5,700sq.m Phase 3: Day Surgery 6 Operating theatres + minor procedures and endoscopy, 100 day beds; 14,000sq.m Phase 4: Rehabilitation/ Long Term Care 300 beds; 20,000sq.m Phase 5: Primary Care Up to 20 GPs, pharmacy and other services; 10,000sq.m	Appraisal



Appendix 2

New Projects and Projects to Progress Through Design

Funding source is the Department of Health

Hospital Group/CHO Area	Capital Reference No.	Facility	Brief Project Description	Status
	11744	Tallaght University Hospital	Build of 72 additional inpatient room facility (3x24 No.), 8 room Endoscopy unit complete with central decontamination facilities & Oncology Day Care unit as a 5-story new build, green site extension to the existing hospital. Total floor area proposed is 7,885sqm.	Appraisal
	11797	Tallaght University Hospital	Fit out of leased units (B11, B12 & B13) Tallaght Cross West, Dublin 24 in order to develop a Women's Health Hub (WHH) which will function as a community based ambulatory Gynaecological Service adjacent to the Tallaght University Hospital Campus.	Design Feasibility
	11653a	Tallaght University Hospital	Phase 2 electrical resilience programme in Tallaght University Hospital. Replacement of transformers at substations 1 & 3, provision of LV generation at substations 1, 3 & 4, upgrade of obsolete MV switches at substations 1, 3 & 4 & new Transformer rooms and associated enabling/ builders work.	Appraisal
	11277	The Coombe Hospital	Refurbish/Upgrade theatres (New Submission - scope has doubled, upgrade 2 theatres & 2 new theatres)	Detailed Design
	11459	The Coombe Hospital	Feasibility study for the Expansion of existing Women's Health Unit through additional consulting/treatment suites (Gynaecology/Colposcopy Lab), 9 No. Consulting rooms (4 No. Colposcopy, 3 No. Gynaecology, 2 No. EPAU) & associated office space. Planning granted. Intended to go to Tender	Detailed Design
	11860	The Coombe Hospital	Upgrades to the existing active and passive fire safety systems following the completion of a Fire Safety Risk Assessment.	Design Feasibility
	11899	The Coombe Hospital	Electrical upgrade/replacement works involving replacement & rewiring of sub-distribution boards in various locations on the campus and associated builder's works.	Appraisal
Ireland East Hospital Group				
	11643	Cappagh	10 bed HDU (7 replacement and 3 additional) & 76 (31 replacement & 45 additional) bed single occupancy ward block and 3 theatres. Project also includes a new OPD, pre-assessment clinic, admissions dept., day ward associated campus works, connecting link to the existing Hospital & site works etc. intended to progress to Detailed Design in 2024.	Detailed Design
	11644	Cappagh	New building to provide additional paediatric radiology, ultrasound imaging and treatment facilities facilities (ground floor), Hospital storage facilities (basement) and a 'shell and core' first floor that can be fitted out in the future to expand the Hospital's education and research activities.	Detailed Design
	11586	Mater Hospital	Mater Major Trauma Centre Phase 2 - Scope to be determined but may consist of elements of a New Trauma Wing (20 Nr ICU Beds; 120 Nr inpatient beds; 4 Nr Theatre Spaces (1 No. shelled); New Laboratory; ED Extension, Clinical Support Space; General Admin Space; Facilities Management space; And additional Radiology (CT and MRI).	Appraisal
	11734	Mater Hospital	Construct new outpatients building (408sqm) on Mater Hospital site, adjacent to Roseary House, for a dedicated Adult Metabolic Service unit. Building will consist of 10 No. consulting rooms and offices for 24 staff. This Service will transfer from it's current location at Temple Street Hospital to the Mater campus.	Design Feasibility
	11753	Mater Hospital	Plan to open existing 3rd CV Lab and increase bed capacity. New 18 bed Coronary Care Unit and turn existing CCU into endocrinology ward.	Detailed Design
	11585B	Mater Hospital	Major Trauma Centre Phase 1C - involves the provision of a rooftop helipad on top of the existing 112 bed ward block and associated ancillary accommodation.	Appraisal
	11745	Mullingar MRH	Refurb of vacated OPD to provide acute floor adjacent to ED for segregated waiting areas and streamlined services. 700sq.m.	Appraisal
	11757	Mullingar MRH	Overall refurbishment for kitchen: fabric, systems, services, equipment.	Appraisal
	11779	NMH Holles Street	Provision of a new external lift core to supplement the existing lift cores within the National Maternity Hospital to mitigate against the Hospital risk register item. The location is at the front of the facility which does not impact on the existing facility	Detailed Design
	11780	NMH Holles Street	Fit out existing shell & core space to facilitate ambulatory gynaecology care facility	Appraisal
	11910	NMH Holles Street	New build 2 storey Anatomical Labs to provide pathology and support services including: A perinatal Post Mortem Suite, Processing Lab, Microtomy Lab, Specialist Stains Lab, Referred Placenta Room, Consultant Offices, Bereavement, Chapel Of Rest & Family Services, Chaplaincy Services, Admin and support facilities. Project replaces Cap Ref # 11022B.	Appraisal
	10005B	NRH Rochestown Avenue	Redevelopment of Hospital Phase 2. Additional capacity, therapy and admin/support accommodation. Intended to progress to Detailed Design	Appraisal
	11714	Our Lady's Hospital, Navan	Upgrade of Our Lady's Hospital Electrical Power Infrastructure from a LV supply to a MV supply. Installation of a new LV Main Distribution Board & Upgrade of electrical backup provision.	Detailed Design
	11804	RV Eye & Ear Hosp	Upgrade of fire alarm and emergency lights.	Appraisal
	11805	RV Eye & Ear Hosp	Phase 1 - fire door project to provide for the repair and recertification together with the replacement of doorsets identified	Appraisal
	11849	RV Eye & Ear Hosp	Repair/ replace existing roof, including survey of existing. Works are also proposed to insulate the roof.	Appraisal
	11911	RV Eye & Ear Hosp	New main entrance lift shaft at the front entrance of the Hospital serving the main 4 floors of the building and the replacement of existing lift.	Appraisal
	11399	St. Columille's Hospital	New building for Weight Management Unit to provide 4 No. Clinic Rooms with bed, 6 No. clinic rooms without bed, 5 No. single offices and , 3 No double offices. Updated Capital Submission received 26/04/2022 for a Weight Management Unit only. Gender Services now going lease route/PCC Cherrywood in long term.	Design Feasibility
	11022F	St. Luke's Hospital, Kilkenny	Refurbishment and extension of the existing mortuary to include a new public entrance and reception area; convert the existing post-mortem room to a family room and kitchen; toilet facilities; deceased member and organ storage area and parking. A new viewing room will be in the new extension.	Appraisal
	11301A	St. Vincent's University Hospital	Development a 7-storey building adjacent to the current Nutley Wing to provide a 28 ICU Beds(including 6 isolation rooms), 70 ward beds, 18 day-case rooms, 8 operating theatres (including 2 oversized hi-tech rooms for robotics) and outpatients. Dependent on Energy Centre.	Appraisal
	11280	Wexford General Hospital	Design, Construction and Equipping of a new MRI facility (174sqm nett) located on a site close to the Main Hospital concourse building and adjacent to ED2 (2 nd MRI operational in Modular temporary facility). Enabling Works at Tender stage.	Tender



Appendix 2

New Projects and Projects to Progress Through Design

Funding source is the Department of Health

Hospital Group/CHO Area	Capital Reference No.	Facility	Brief Project Description	Status
RCSI Hospital Group				
	11337	Beaumont	New Emergency Department and reconfiguration of existing Department - including road realignment.	Detailed Design
	11564	Beaumont	Freehold Acquisition of Beaumont Convent & upgrade for admin accommodation (119 spaces).	Detailed Design
	11717	Beaumont	Provision of Critical Care beds over four floors in a new building. A decant of the existing Endoscopy Dept. to a new two story building (7 No. procedure rooms) is required to create a site for the Critical Care Unit. Intended to progress to Detailed Design	Design Feasibility
	11807	Beaumont	Construction of a 13th Operating Theatre and associated support rooms to be located in an existing internal courtyard adjacent to the existing Operating Theatre Block. A dedicated plant room, will be constructed at First Floor level above the new theatre.	Design Feasibility
	11865	Beaumont	Upgrade inner MV ring main to cater for proposed new developments and Climate Action requirements: -New energy centre for future developments -Electrical infrastructure to facilitate new sub-station -Upgrade existing sub-stations & infrastructure - Additional generator capacity and space for future -New MV and LV feeder cables Works will increase capacity from 2.0MVA to 11.4MVA	Appraisal
	11866	Beaumont	Proposed road realignment to improve access to critical infrastructure and development areas. Includes new cycling infrastructure.	Appraisal
	11867	Beaumont	Construction of additional Car Park deck with 3,000m ² Solar PV Canopy.	Appraisal
	11868	Beaumont	Construction of new three storey suspended car park deck(s) with a solar PV canopy, above the existing southern surface carpark (car park 10). Land currently occupied by 400 car parking spaces will be used to facilitate a number of campus development projects (incl. new ED, NPRO Ph2)	Detailed Design
	11869	Beaumont	Installation of a 3rd CT Scanner into the Radiology Department to give ED more timely access to CT and improve patient flow through the ED department as well as reduce CT OPD waiting lists.	Appraisal
	11966	Beaumont	Two storey building to establish a 4 trolley/chair recovery ward in the courtyard next to the Cath Lab to monitor patients after procedures. The lower ground floor will be used to create storage for the pharmacy and clinical trials.	Appraisal
	11967	Beaumont	Establishment of a 6 bed interventional radiology Day Ward to coordinate the interventional radiology care pre-procedure, and monitor patients after their procedures. Space is available in the former mammography dept. for use.	Appraisal
	11969	Beaumont	Dedicated space for delivery of care to frail elderly patients within the ED consisting of 4 treatment bays, consulting space and assessment space.	Appraisal
	13064	Beaumont	Construction of a new 95 Inpatient Bed Accommodation. The project will include 19 en-suite bedrooms per floor, with 2 per floor facilitating full isolation, full support facilities along with a component of back up stores and staff changing along with relevant building interconnections to existing hospital buildings.	Detailed Design
	11782	Beaumont St. Joseph's, Raheny	Proposed stand-alone diagnostic centre on the St Joseph's site under the governance of Beaumont Radiology Dept. The development will consist of; 3 Ultrasound Rooms, 4 X-Ray rooms, Radiology led CT and MRI, Cardiology led CT and MRI & Relevant support services Proposed Floor Area - 1135sqm	Appraisal
	11650	Cavan General Hospital	New 3 storey extension block to the northern side of the existing front hospital entrance to provide Oncology Unit (70% additional capacity). Upgrade of the existing Pharmacy and a new Aseptic Unit. Relocation of the Physio Dept from the HSPC inpatient assessment area and allow the HSPC space to become an 8 bed day ward/post theatre recovery area (works to HSPC not in this project). Medical training element removed for NC&PSC.	Design Feasibility
	11718	Cavan General Hospital	Various electrical upgrade/replacement works to main electrical distribution network. - The existing single circuit maximum voltage (MV) switchboard be replaced with a 6 – circuit unit - Existing T1 will be reused to supply a portion of the site with T2 when added will supply the remainder of the site. Provision will be left for T3 for future developments on the site - Construction of new substation closer to the primary load centre with associated MV and LV switchgear and back up supply by generator. - The 3 no. existing Low voltage boards to be replaced - Installation of new MV and LV feeder cables	Detailed Design
	11188A	Cavan General Hospital	New three story extension block housing a New Endoscopy Unit (3 No. procedure & 2 No. recovery rooms), 18 bed ward accommodation (16 No. single rooms with en-suites) (and 2 no of isolation rooms)and the relocation of the existing ED Department (2 No. Resus, 10 No. Majors, 6 No. Minors, 3 No. Paeds & 3 No. Iso. rooms).	Detailed Design



Appendix 2

New Projects and Projects to Progress Through Design

Funding source is the Department of Health

Hospital Group/CHO Area	Capital Reference No.	Facility	Brief Project Description	Status
	11739	Connolly Hospital Blanchardstown	Ground Floor - 2nd CT: Extend Radiology & provide 2nd CT First Floor - Replace 5 existing ICU beds with HTM / HBN compliant ICU beds. These 5 ICU beds together with an existing ICU isolation room will provide 6 ICU beds in total. The remaining 4 beds in the existing ICU footprint will be converted to a 4 bed CCU. The existing ground floor CCU ward will be used to provide general ward bed accommodation for up to 6 patients. Second Floor - Creation of three new HBN-compliant theatres.	Design Feasibility
	11762	Connolly Hospital Blanchardstown	Project to replace (phased) ventilation systems in Theatres, ICUs, some isolation Rooms, CCU and endoscopy, as well as stabilise/ mitigate certain risks during replacement.	Detailed Design
	11871	Connolly Hospital Blanchardstown	Provision of a second MRI Scanner Suite, between the radiology and outpatients depts.	Appraisal
	11961	Connolly Hospital Blanchardstown	Possible provision of an additional 15 beds at either the Beech or Holly wards. Scheme to be further developed at Capital Submission stage.	Appraisal
	13007	Connolly Hospital Blanchardstown	New Project: Theatres: Theatre upgrade to allow Emergency specific theatre and consequent Covid specific dedicated theatre High Priority but interim solution	Detailed Design
	11965	Our Lady of Lourdes Hospital	Provision of two new MRI Scanners & associated works to replace two scanners (1 public, 1 private) currently provided through SLA.	Appraisal
	13068	Our Lady of Lourdes Hospital	Replacement of existing OPD Modular building to Crosslanes (20 years old and in poor condition) with an extended two storey building (Phase 1 OPD). This will provide improved and additional Outpatients capacity and improved social distancing.	Design Feasibility
	11338	Rotunda	Acute Care Block (West Wing redevelopment and extension), NICU & other priorities tbc, see Cap Ref 1620 - fit out of rental solution.	Design Feasibility
	11937	Rotunda	Proposed upgrade of campus electrical services. Feasibility study to be completed initially.	Appraisal
Saolta University Hospital Group				
	11793	Galway City East	Purchase and fit out of building in Galway City (BMR House, Parkmore). Surveys associated with property purchase to progress.	Design Feasibility
	11543	Letterkenny University Hospital	Electrical Infrastructure Upgrade, 1980's building. Phases 2 & 3. Equipment purchase in 2021	Detailed Design
	11544	Letterkenny University Hospital	Boiler replacement (Enabling works 2022, new gas tank)	Detailed Design
	11601	Letterkenny University Hospital	New Aseptic Compounding unit. Extension and reconfiguration of the existing	Design Feasibility
	11651	Letterkenny University Hospital	Flat roof covering repair and balcony spalling repair works.	Design Feasibility
	11851	Letterkenny University Hospital	Relocate existing AMAU and admin accommodation to a new extension (538sqm) providing 6 no. single rooms. Reconfigure vacated space to provide additional enclosed single ED cubicles (6 No.) & to create separate enclosed ED Paediatric Treatment single cubicles (4 No.) and a stand-alone waiting room.	Appraisal
	10027A	Letterkenny University Hospital	Fire Safety Works to Medical Ward Block (scope of works under review, may not be required - possible fire engineering solution)	Detailed Design
	11017C	Letterkenny University Hospital	Renal Dialysis expansion. Increasing Capacity from 14 to 21.	Detailed Design
	11368	Mayo University Hospital	Update Development Control Plan, hospital campus and adjacent lands in conjunction with Mayo Co Co local area plan	Detailed Design
	11428	Mayo University Hospital	New ground floor extension to ED & reconfiguration of existing ED (7 additional ED assessment & treatment spaces) New first floor MAU at first floor (10 spaces) Reconfiguration of C Ward to facilitate the new build tie-in and provide additional isolation rooms	Detailed Design
	11808	Merlin Park University Hospital	Phase 2 of new OPD to provide 77 additional consulting rooms, associated treatment rooms, and other associated facilities. Linked to Cap Ref # 11143b.	Appraisal
	11873	Portiuncula University Hospital	Construction of 2nd MV substation incorporating 2x MV transformers, ring main unit, associated switchgear, LV supply, standby generator etc.	Design Feasibility
	11874	Portiuncula University Hospital	ED expansion to increase no. of bays by 9 (currently 14 treatment and 2 resus). This will provide capacity to deal with children in a segregated area of ED. Support facilities such as wc's shall also be provided. Intended to progress to Detail Design	Appraisal
	11914	Portiuncula University Hospital	Replacement of Central Sterile Services Decontamination (CSSD) Unit for Reusable Invasive Medical Devices This will also provide a service for Roscommon UH.	Appraisal
	11915	Roscommon University Hospital	Refurbishment of Radiology dept. to include construction, plant and infrastructure upgrades to facilitate the installation of a replacement CT scanner as part of the ERP.	Appraisal
	11447	Sligo University Hospital	Upgrade of existing Macular Treatment room and creation of a second room. Extra space to perform increased injection therapies and ophthalmic surgery	Design Feasibility
	11626	Sligo University Hospital	The Installation of a Second CT scanner at SUH - Included in these works is a new build consisting of approx. 120m2 for the relocation of Nuclear Medicine, reconfiguration of existing Nuclear medicine with extension to take Second CT Scanner accompanying requirements.	Detailed Design
	11875	Sligo University Hospital	Refurbishment (674sqm) of existing Rehabilitation ward accommodation at St. Johns Hospital to provide 26 additional acute Inpatient bed Accommodation, for lower complexity cases.	Detailed Design
	11898	Sligo University Hospital	Feasibility for Surgical Hub	Appraisal
	11143	University Hospital Galway	Development of a refreshed masterplan (including for new Emergency Department with Ward Block over (Maternity & Paediatric inpatient beds)	Detailed Design
	11476	University Hospital Galway	Provision of a new helpipad	Detailed Design
	11627	University Hospital Galway	New Medical Laboratory building to house all existing laboratory services in one as a replacement to existing prefab accommodation. Part of refreshed masterplan. Intended to move to detailed design.	Design Feasibility



Appendix 2

New Projects and Projects to Progress Through Design

Funding source is the Department of Health

Hospital Group/CHO Area	Capital Reference No.	Facility	Brief Project Description	Status
	11720	University Hospital Galway	Replacement of 3 No. main public lifts (main ward block), 1 No. goods lift (main ward block).	Design Feasibility
	11840	University Hospital Galway	New cancer centre incorporating inpatient beds, theatres, ICU/CCU beds, ambulatory care facilities, diagnostics and associated admin supports with direct connection links to the existing main hospital. Associated laboratory facilities provided under project # 11627. Part of refreshed masterplan. Intended to move to detailed design.	Appraisal
South South West Hospital Group				
	11545	CUH	Expansion of the Dunmanway Day Unit (DDU) which provides Haematology/Oncology treatment from the current 15 (repurposed) treatment spaces to 25 with a corresponding increase in ancillary areas.	Design Feasibility
	11546	CUH	CUH Aseptic Compounding Unit within the footprint of the vacated radiation oncology building. Same DT as 11545	Design Feasibility
	11841	CUH	Purchase and fit out of building at Cork Business & Technology Park, Model Farm Road, Cork (former Abtran building) to accommodate non patient facing personnel from CUH.	Appraisal
	11941	CUH	Provision of a new Hybrid theatre within the existing Theatre Complex on the Ground Floor (768sqm)	Appraisal
	11943	CUH	Proposed new/additional third MRI for CUH to be procured and installed in current shell and core unit in the Glandore Centre.	Appraisal
	11944	CUH	Proposed conversion of an existing 6-bed open plan adult ward and adjacent space to 2 No. single ensuite rooms for paediatric haematology/oncology, 4 No. oncology treatment couches and associated space. This will facilitate paediatric services being transferred from the Mercy Hospital.	Appraisal
	10532A	CUH	Paediatric Department Phase 2; Inpatient bed provision including 82 replacement beds/cots (48 children beds, 24 infant beds, 6 HDU beds, 4 oncology/haematology beds - Mercy & CUH), 3 theatres, 1 procedure room and associated accommodation.	Detailed Design
	11945	CUH	Trauma, Acute Beds & Critical Care (TACC) Tower	Design Feasibility
	11751	Mallow General Hospital	Fit out of existing 1st Floor (1631sqm) shell & cores space to provide 24 bed inpatient ward. Fit out of existing Ground Floor (1602sqm) shell & core space to provide Outpatient/Day Clinic ward to include 15 standard clinical rooms, and an additional 5 clinical rooms configured for the establishment and operation of an Obesity / Bariatric Clinic.	Appraisal
	11916	St. Finbarr's Hospital	Reconfiguration of existing ground floor to create 5 no beds, wc's, staff facilities & associated accommodation. Vertical extension to existing single storey ward block to provide 19 beds. Follow on project to Cap Ref # 13039.	Appraisal
	11876	St. Mary's Health Campus, Cork	Development of a Barnahus South service for children and young people following concern or disclosure of sexual assault/abuse and a replacement Sexual Assault Treatment Service. Project funded 50/50 with Tusla.	Appraisal
	11227	Tipperary University Hospital	OPD including staff change attached to existing main hospital. Stage 2A to be submitted to go to NC&PSG	Detailed Design
	11784	Tipperary University Hospital	Construction of permanent streamed COVID waiting areas complete with indoor public presentation/pre-assessment counter, static security kiosk, check-in counters and dedicated pathways to the ED. First floor shell for future development for support space for ED. Second floor shell for future development (plant).	Appraisal
	11267	University Hospital Kerry	Upgrade and extension to the Oncology Day Ward - roof top vertical extension over the existing Palliative Care ward. Scope includes 14No day treatment cubicles plus 2No day treatment isolation rooms & 7No outpatient consultation rooms. Aseptic compound unit is included.	Detailed Design
	11449	University Hospital Kerry	Provision of new addressable emergency lighting system	Detailed Design
	11568	University Hospital Kerry	Refurbish an existing ward to create of 5 No. new single en-suite rooms in an existing admin area (Rathass Ward -orthopaedics), and associated accommodation.	Design Feasibility
	11810	University Hospital Waterford	Two storey extension to the existing UHW laboratory providing, specimen delivery and despatch, analytical office / workstations, locker room and on call accommodation	Detailed Design
	11811	University Hospital Waterford	Proposed 2 floor vertical extension over existing OPD to provide an additional 36 consulting rooms, 4 treatment rooms, 4 measurement rooms and 2 virtual consultation rooms. 2,002 sq.m total incl 2 No. new levels, plant room and alterations to existing levels. Intended to progress to Detailed Design	Appraisal



Appendix 2

New Projects and Projects to Progress Through Design

Funding source is the Department of Health

Hospital Group/CHO Area	Capital Reference No.	Facility	Brief Project Description	Status
University of Limerick Hospital Group				
	11603	Ennis General Hospital	New Theatre block (2 No. theatre and associated accommodation, 4 No. recovery bays) and CSSD, and associated refurbishment, move VIE	Detailed Design
	10635	University Hospital Limerick	Maternity Relocation to UHL Campus.	Appraisal
	11451	University Hospital Limerick	Production Kitchen/Catering Upgrade (Equipping part purchase in 2020). Complex project, enabling works	Design Feasibility
	11484	University Hospital Limerick	Reconfiguration and extension to current Radiology Department and provision of a 2nd MRI (additional)	Detailed Design
		University Hospital Limerick	16 Additional Beds to support capacity expansion at UHL - *May update*	Detailed Design
	11113b	University Hospital Limerick	Phase 2 of 2nd Ward Block (4x24 beds) located over lower floors constructed under Cap Ref # 11113a. The scale of the development envisaged is approximately 14,470sqm. Enabling works in Construction	Detailed Design
	11113c	University Hospital Limerick	Acute Medical Floor (incl. AMAU, GEM unit and CDU relocation). Intended to progress to Detailed Design	Appraisal
National				
	11845	National Programme	Additional Acute Bed Capacity Expansion Programme.	Appraisal/Design/Tender
	11842	St. Stephen's Hospital	New Elective Hospital. Inteded to progress to Detailed Design.	Detailed Design
	11843	Merlin Park University Hospital	New Elective Hospital. Inteded to progress to Detailed Design.	Detailed Design
	11844	Dublin Site A	New Elective Hospital. Inteded to progress to Detailed Design.	Progressing To Detailed Ddesign
	11844a	Dublin Site B	New Elective Hospital. Inteded to progress to Detailed Design.	Progressing To Detailed Ddesign
	12900	Various	Placeholder for various high priority projects for 2024 for which Capital submissions have yet to be finalised/submitted.	Appraisal
	11022A	Design & Dignity, National Mortuary Programme	National Mortuary Capital Programme to review the existing facilities and upgrade/refurbish sub-standard public hospital mortuaries to ensure they are in line with best practice standards	Appraisal



Appendix 2

New Projects and Projects to Progress Through Design

Funding source is the Department of Health

Hospital Group/CHO Area	Capital Reference No.	Facility	Brief Project Description	Status
Radiation Oncology				
Dublin Midlands	10008H	St. James's	The provision of Phase 2 facilities at St James's Hospital.	Appraisal
Dublin Midlands	11907	St. Luke's Hospital, Rathgar	New Main Electrical Distribution Board, new Generator and new switch gear.	Appraisal
Dublin Midlands	11908	St. Luke's Hospital, Rathgar	New Nuclear Medicine Gamma Camera scanner room and control room (modular) and ground works to house replacement Gamma Camera. Replacement equipment is listed in ERP.	Appraisal
RCSI Hospitals	10008F	Beaumont	The provision of Phase 2 facilities at Beaumont Hospital (includes equipping). 3 Enabling works packages.	Detailed Design
University of Limerick Hospital Group	10008J	University Hospital Limerick	Linacs Refreshment/Replacement Programme (including CT)	Appraisal
National	10008I	Radiation Oncology	Linacs Refreshment/Replacement Programme St Luke's, Rathgar, St James & Beaumont (may include equipping Phase 2 Beaumont). Design Build Equip and Maintain.	Appraisal

Ambulance				
	10275	Sligo	Construction of a new ambulance station (1423sqm) with regional training and education facility over two floor levels on a greenfield site. Site is standalone with no obstructions to major road networks.	Appraisal
	10447	Caherciveen	Provision of a new Ambulance Station Caherciveen Community Hospital (new proposal being considered - possible lease solution)	Design Feasibility
	10458	Limerick	Provision of a new Limerick Ambulance Base.	Detailed Design
	10461	Dundalk	New ambulance station (1500sqm) on a green field site in Dundalk. Accommodation will consist of general admin, office, rest and staff rooms, kitchenette & dining, toilets & stores, sluice and laundry rooms, staff changing & locker rooms, ICT room, training & meeting rooms, record room, plant room, 3 vehicle garage and canopy for 16 vehicles with a wash bay.	Appraisal
	10510	Middleton	Provision of a replacement Ambulance Station, Middleton. HSE site	Design Feasibility
	11071	Gorey	Allocation for feasibility study is provided to support site acquisition in 2024	Design Feasibility
	11167	Cork City	Ambulance Base and HQ to serve Cork City & County in grounds of St Finbarr's Hosp	Detailed Design
	11530	Athlone Ambulance Base	New ambulance station (1500sqm) on a green field site in Dundalk. Accommodation will consist of general admin, office, rest and staff rooms, kitchenette & dining, toilets & stores, sluice and laundry rooms, staff changing & locker rooms, ICT room, training & meeting rooms, record room, plant room, 3 vehicle garage and canopy for 16 vehicles with a wash bay.	Appraisal
	11556	Mallow Ambulance Base	New Ambulance Base, Mount Alvernia.	Detailed Design
	11579	Glen Abbey, Belgard Road	New Ambulance Base at the HSE owned Glen Abbey complex, Belgard Road, Dublin. This base replaces the Tallaght base operating from a leased facility at Airton Road. Base will also house NAS Critical Care Retrieval Services (NAS CCRS) operating from Cherry Orchard. Base will also provide resilience for the National Emergency Operations Centre (NEOC).	Detailed Design
	11652	Recess HC, Connemara	Refurbishment of existing 1960s Health Centre and ambulance parking for use as NAS dynamic deployment base in Connemara.	Detailed Design
	11838	Carlow Ambulance Base	New Ambulance Station (1150sqm new build + 571sqm renovation), Regional Training Facility and business support hub by developing a greenfield site and renovation of Kelvin Grove House.	Design Feasibility
	11925	Buncrana	Renovation of an existing HSE health centre at McGinn Avenue, Buncrana (190sqm) and conversion to an ambulance base.	Appraisal
	11953	Ballinasloe Ambulance Base	New standalone Ambulance Base on a greenfield site. GIFA >1,500sq.m	Appraisal
	11954	NAS Training College, Cork	Proposal to develop a tertiary education facility (1819sqm) campus to conduct 3rd-level accredited training. Lecture rooms, offices, etc. This facility will be in addition to training facilities in Dublin, Tullamore & Ballinasloe.	Appraisal
	11955	Waterford Ambulance Base	New standalone Ambulance Base on a greenfield site. GIFA >1,550sq.m	Appraisal
	11956	Wexford Ambulance Base	New standalone Ambulance Base on a greenfield site incorporating Emerging Threat Team (ETT) facility.	Appraisal
	11957	Clonmel Ambulance Base	New standalone Ambulance Base on a greenfield site. GIFA >850sq.m	Appraisal
	11958	Tullamore Ambulance Base	New standalone Ambulance Base on a greenfield site incorporating Emerging Threat Team (ETT) facility, Ambulance Health Region HQ and Training Facility. GIFA >2,550sq.m	Appraisal
	11959	Finglas Ambulance Base	New standalone Ambulance Base on a greenfield site. GIFA >1,600sq.m	Appraisal
	12910	Urlingford Ambulance Base	Possible building purchase (old fire station) & refurbishment	Appraisal



Appendix 2

New Projects and Projects to Progress Through Design

Funding source is the Department of Health

Hospital Group/CHO Area	Capital Reference No.	Facility	Brief Project Description	Status
Community Care (Disability - Shared Projects)				
Enhanced Community Care				
CHO 1	13230	HUB 01 - St. Conals, Letterkenny	Extension (200sqm) to existing Chronic Disease Management Hub to provide support accommodation.	Detailed Design
CHO 1	13231	HUB 03 - St. Johns Campus, Sligo	Refurbishment of an existing single storey office block (140sqm), and an extension (345sqm). The overall project will provide office accommodation, clinic rooms, receptions etc.	Detailed Design
CHO 1	13238	Spoke 2A - Monaghan General Hospital	Refurbishment of existing Ambulance base, located on the grounds of Monaghan GH, consisting of:- Refurb of Monaghan Ambulance Base as ECC spoke 140sq.m providing clinical space as well as offices storage and staff facilities.	Design Feasibility
CHO 1	13255	HUB 01 - St. Conals, Letterkenny	New building to house ECC Hub (2824sqm) to include ICPOP, ICPCD, Diagnostics etc. A road realignment is required as enabling works.	Appraisal
CHO 1	13256	HUB 02 - Cavan General Hospital	New building to house ECC Hub (1520sqm) to provide a base for a ICPOP & ICPCD. Provision of a new CDM Hub on the grounds of CGH	Appraisal
CHO 1	13257	HUB 03 - Clarion Road, Sligo	New two storey building to house ECC Hub (3043sqm). The building will provide office and clinical accommodation to the ICPOP, ICPCD, Diagnostics and Community Health Network Team.	Appraisal
CHO 2	13227	HUB 04 - Galway City, Knocknacarra	Purchase & fit out of Block A Galway West Business Park, Knocknacarra, Galway	Detailed Design
CHO 2	13260	HUB 06 - Cedar House, Castlebar	CST interim lease in Castlebar to free up capacity in the County Clinic as they await the operationalisation of the permanent solution.	Appraisal
CHO 3	13223	Hub 07 - St. Joseph's Hospital, Mulgrave Street, Limerick Interim Solution	Works associated with the installation of a rented modular unit on the grounds of St Joseph's Hospital as an interim solution for the ICPCD team until the permanent Primary Care Centre at St Joseph's Hospital is complete.	Design Feasibility
CHO 3	11747	Hub 07 - St. Joseph's Hospital, Mulgrave Street, Limerick	Proposed new Primary Care Building, green field site.	Appraisal
CHO 4	13204	HUB 10 - St. Mary's Health Campus, Cork	New build extension, upgrade and refurbishment of existing accommodation to provide clinical rooms, offices, gym for cardiac and pulmonary rehabilitation, education room, as well as diagnostic services etc.	Design Feasibility
CHO 4	13254	HUB 11 - Mallow Business Park	Interim accommodation solution, fit out of leased buildings (Blackwater House & Mallow PCC).	Detailed Design
CHO 5	13245	HUB 13 - Kilkenny	Refurbish the Community Care Health Centre know as James Green to incorporate on an interim basis members of the Chronic Disease Hub in Carlow/Kilkenny	Detailed Design
CHO 5	13239	Hub 14 - Waterford	Refurbish part of St Otterans & St Patricks incorporating an extension to house diagnostics to provide a permanent location for ICPCD & ICPOP for Waterford covering two CHNs. Total floor area = 2381sqm.	Detailed Design
CHO 5	13246	HUB 13 - Kilkenny	Fitout of existing building to be leased at Oriel House, Ourath, Loughboy, Co. Kilkenny to facilitate the Integrated Programme Older Persons (ICPOP) Team.	Detailed Design
CHO 5	13250	HUB 15 - St. Patrick's Hospital, Cashel	Refurbishment of 1239sqm in St Patricks Hospital, Cashel to provide interim accommodation for CHN teams for Central Tipperary.	Detailed Design
CHO 5	13253	HUB 15 - Clonmel ECC Hub Interim	Refurbishment works to three existing HSE building (260sqm + 192sqm + 180sqm = 632sqm) on the grounds of St. Luke's Campus, Clonmel.	Detailed Design
CHO 5	13258	HUB 16 - Tincone, Wexford	Interim location for CDM hub and some primary care ICPOP and CHN services. Permanent extension, 1792sqm, to existing PCC in Wexford for CHN team for Southeast Wexford, and outreach bookable rooms for the ICPOP and ICPCDM teams for Wexford (which will be based in Enniscorthy).	Design Feasibility
CHO 6	13206	HUB 17 - Clonskeagh	New 2-storey building including an underground car park constructed on a green field site on an area of the HSE owned Clonskeagh Campus site in order to deliver Enhanced Community Care. The building will include basement car parking.	Design Feasibility
CHO 6	13207	HUB 18 - Cabinteely	Extension of Cabinteely Health Centre to create accommodation for CHN's.	Appraisal
CHO 6	13208	HUB 18 - Carrickmines	Proposed fit out costs associated with the lease of a building, Iveagh Building, (3048sqm) to allow the decant of Bray Civic Centre for use by ECC.	Design Feasibility
CHO 7	13209	HUB 19 - City Lodge, The Meath Campus	Refurbish existing HSE building at City Lodge, Meath Campus to provide space for approximately 33 No. staff and meeting space, CD. Protected structure	Design Feasibility
CHO 7	13211	HUB 20 - Cherry Orchard	Minimal refurbishment of Cuan Dara to establish ICPCD team/hub in this location as an interim solution until the longer term option is ready. Approximately 1023sqm gross available to refurbish/repurpose.	Detailed Design
CHO 7	13214	HUB 22 - Hawthorn Building, Naas	Fit out of leased building (Hawthorn) to decant not clinical services from St Mary's (and other buildings) for use by ECC.	Design Feasibility
CHO 7	13215	HUB 22 - St Mary's, Naas	Repurpose and refurbish existing HSE accommodation in St Marys at Naas General Hospital to provide short term accommodation for Enhanced Community Care ICPOP & Chronic Disease Management Services.	Detailed Design
CHO 7	13232	HUB 20 - Cherry Orchard	Proposed construction of a new building (3000sqm) at Cherry Orchard to accommodate an ECC Hub (1825sqm), 3 CHN teams (800sqm) and expansion space for Ballyfermot Primary Care Centre 2 (375sqm).	Design Feasibility
CHO 7	13259	HUB 19 - Terenure PCC	Proposed new ECC Hub & PCC to house 2 No. GP practices (372sqm), ECC Hub with 3 CHN teams (2600sqm) on a HSE owned site (currently a public carpark). Site is also to incorporate services for: (1)Evergreen Services [older persons services-S39] (537sqm) and (2) Dublin City Council (420sqm).	Appraisal
CHO 8	13233	HUB 23 - MRC Mullingar	Reconfigure Mullingar Resource Centre (942sqm) to facilitate establishment of ICPOP specialist Team and ICPCD team (interim) pending the development of a permanent facility.	Detailed Design
CHO 8	13235	HUB 24 - Tullamore Health Centre	Provision of new modular build to provide interim accommodation for ICPOP hub with ICPCDM outreach service	Design Feasibility
CHO 8	13241	HUB 23 - Mullingar MRH	New build facility adjacent to new OPD at Mullingar Regional Hospital to provide a Hub for ICPOP and ICPCD. 2 floors with carpark, site works etc.	Appraisal



Appendix 2

New Projects and Projects to Progress Through Design

Funding source is the Department of Health

Hospital Group/CHO Area	Capital Reference No.	Facility	Brief Project Description	Status
CHO 8	13242	HUB 24 - St. Fintan's Portlaoise	New build facility to provide both Interim and long term accommodation solutions on a phased delivery for ICPCDM hubs with ICPOP outreach service. Phase 1 will comprise the Interim hub and phase 2 will involve the fit-out of the remainder of the new build to provide the long term Hub	Appraisal
CHO 8	13247	Hub 25 - Boyneview House, Drogheda	Reconfiguration and refurbishment of HSE Boyneview House - interim solution for ICPOP & CD	Design Feasibility
CHO 8	13261	Boyne Centre, Drogheda	Fitout of new lease for additional space for Boyne PCC, interim solution for CST 25	Appraisal
CHO 9	13216	HUB 27 - Ballymun PCC	Reconfiguration of existing Primary Care Centre administration areas for the provision of Enhanced Community Care complete with ancillary site works. Approximately 2400 sqm. (Includes fitout of Tusla space in Ballymun)	Design Feasibility
CHO 9	13217	HUB 30 - Corduff PCC	Extension to HSE owned Corduff Primary Care Centre to provide 2000sqm for Enhanced Community Care complete with ancillary site works. It is proposed to expand the existing building with an additional wing of clinical rooms and admin space for the Connolly CDM team & Blakestown CHN.	Design Feasibility
CHO 9	13249	Interim CHN Accommodation (Coastal & Clontarf)	Refurbishment and Fit out of Units at Bayside Shopping Centre for Clontarf and Coastal CHNs Interim accommodation hub for both CHNs. 5 clinical rooms, 2 single offices. Open plan office for 34 staff, group room, clinical store room, staff canteen, cleaners store, dirty utility, staff toilets, public toilets, waiting area.	Detailed Design
CHO 9	13252	Charlestown Shopping Centre	ICDM CST30 Interim Accommodation while a new PCC solution in the long-term is awaited	Detailed Design
Health & Wellbeing				
CHO 1	11641	Cloonamahon	HSE contribution to public park. This allocation, income from sale of lands to NRA for N4 road realignment, to upgrade the old farmyard and orchard to create a sensory garden and horticulture area, for use by disability and mental health day services.	Appraisal
National	11108C	National Cancer Screening Service	Equipment Replacement Programme (BreastCheck) 2021 to 2026.	Appraisal
Mental Health				
CHO 1	11918	Cavan General Hospital	New 30 bed AAMHU to replace existing 25 bed unit on the grounds of Cavan General Hospital.	Appraisal
CHO 2	11486	Castlebar	Refurbishment and small extension of two High Support Community Residences, An Coilin & Teach Aisling to appropriately accommodate 9 residents in 2 residential units.	Appraisal
CHO 3	10127	St. Joseph's Hospital, Limerick	Community C&A Mental Health Facility in grounds of St Joseph's (to accommodate services currently in inappropriate (mostly rented) accommodation)	Detailed Design
CHO 3	11919	St. Camillus's Limerick	Reconfiguration of Tearmann Unit (206sqm) to include the reduction of multi occupancy dormitories and increasing bathroom facilities on the unit. Tearmann Unit is an approved centre consisting of a 15 bed assessment unit for people with advancing dementia, psychological and behavioural symptoms.	Appraisal
CHO 4	11266	Mercy University Hospital	Refurbish and upgrade the existing St Michael's Ward to bring accommodation up to standard as an interim solution. Long term proposal is a new unit (no of beds to be determined), site location to be determined.	Design Feasibility
CHO 4	11749	St. Finbarr's Hospital	20 bed Mental Health unit with single, en-suite rooms at St. Catherine's Unit. Older persons, continuing care and rehabilitation facilities. Will incl. reception, administration areas and shared facilities. Will also provide a range of therapy services.	Design Feasibility
CHO 4	11750	St. Stephen's Hospital	New 50-bed Mental Health unit with single, en-suite rooms. Older persons, continuing care and rehabilitation facilities. Will incl. reception, administration areas and shared facilities. Will also provide a range of therapy services.	Design Feasibility
CHO 4	11767	Owenacurra, Middleton	Purpose-built 10-bed Community Rehabilitation Residence (CRR) with single room en-suite accommodation as separate "households" to facilitate resident-directed care.	Design Feasibility
CHO 4	11920	Bantry General Hospital	Provision of reduced ligatures across the approved mental health centre addressing the regulatory findings of the MHC while providing additional communal space for residents of the Approved Centre.	Detailed Design
CHO 5	11730	University Hospital Waterford	Replacement of the existing AAMHU 44 bed multi bed unit at UHW with a 50 bed single bed unit, incorporating Acute beds, Psychiatry of Old age, Hi Obs area, ECT	Appraisal
CHO 5	12902	St. Luke's Hospital, Kilkenny	New 50 bed AMHU.	Appraisal
CHO 6	11485	St. Vincent's University Hospital	Proposed 50 Bed adult Acute MH Unit. Project now proposed for St. Vincent's University Hospital, Elm Mount instead of St. Columcille's. Feasibility study for SVUH option in 2023.	Design Feasibility
CHO 6	11853	Clonskeagh	Provision of an extension (1035sqm) to an existing building to expand the existing Acute Day Hospital, co-locate a centralised clozapine clinic and the future development of a crisis assessment and response '7/7' service.	Appraisal
CHO 6	11877	St. Vincent's University Hospital	Reconfigure existing windows to reduce/ remove ligature points. This will involve electrical works for actuators etc.	Appraisal
CHO 7	11271	Naas General Hospital	New 50 Bed Acute MH unit (Lakeview), including 9 Intensive Care Beds, to replace existing. Scope under review (No 1 MH priority).	Detailed Design
CHO 7	11321	Celbridge	High Support Community Residence - 10 Beds	Detailed Design
CHO 7	11322	Tús Nua, Kildare Town	A High Support Community Residence with 10 en-suite bedrooms & 12 no. one-bedroom, own door units to include outdoor space and indoor communal multi-function area. Refurbish existing protected structure (St. Jude's House) & reconfigure/upgrade existing outdoor space (EVE Harvest) for recovery oriented Horticultural and Recreational programmes.	Appraisal
CHO 7	11610	Bride Street Health Centre	Complete refurbishment of Bride Street Health centre to accommodate a Specialist Mental Health homeless MDT (15 people) and the Health Inclusion Team (10 people).	Design Feasibility



Appendix 2

New Projects and Projects to Progress Through Design

Funding source is the Department of Health

Hospital Group/CHO Area	Capital Reference No.	Facility	Brief Project Description	Status
CHO 7	11878	St. James's	Reconfiguration of the existing AMHU. Reconfiguration (2195sqm) & extension (170sqm) will consist of relocating the acute ward to the ground floor with access to outdoor space, improve existing PoLL ward at first floor and create a less acute ward at first floor. The bed numbers will reduce from 47 to 40 and bedrooms (12 acute beds, 18 less acute, 10 PoLL). Existing OT dept. will have to relocate (no details provided)	Appraisal
CHO 8	11284	Birchwood House, Tullamore	High Support Community Residence - 10 Beds. Stage 2A currently	Detailed Design
CHO 8	11287	Mullingar	Refurb to provide accommodation for MH Day Centre & Rehab psychiatry team @ Green Road, Mullingar	Appraisal
CHO 8	11288	St. Vincent's Hospital, Athlone	New 9 bedded High Support Hostel (all single rooms en-suite) built on the grounds of St Vincent's Hospital Campus in Athlone. This unit will replace the existing Glenavon High Support Hostel which has been determined to be not cost effective to upgrade.	Appraisal
CHO 8	11289	Ashford House, Longford	Proposed new 9 bedded High Support Hostel (all single rooms en-suite) built on the site previously purchased on the Dublin Road, Longford. This unit will replace the existing Ashford House High Support Hostel, Longford.	Appraisal
CHO 8	11290	Bridge Street, Portlaoise	New Community Mental Health centre, replacing Triogue	Appraisal
CHO 8	11292	St. Fintan's, Laois	New 20 bed high support Community Residence (2 No. 10 Bed Units)	Appraisal
CHO 8	11599	Our Lady of Lourdes Hospital	Psychiatry of later life unit (PoLL) – proposed 10 bed extension. Feasibility Study completed.	Detailed Design
CHO 8	11741	Mullingar	Primary Care Unit building, St Lomans Campas Mullingar. Refurbishment, fabric upgrade, lift installation, asbestos removal and upgrade of IT systems for Mental Health Services, Pharmacy, Mental Health Tribunal Suite and HSE office accommodation. Existing services have been decanted elsewhere and the building is currently unoccupied.	Appraisal
CHO 8	10669A	St. Fintan's, Laois	Refurbishment Works for CAMHS Team 3 in St Fintan's Hospital Portlaoise	Design Feasibility
CHO 9	11502	Finglas	Provision of a purpose built 10 High Support Community Residence to provide accommodation for the residents of Cherrymount, North Circular Road. Purchase of site in 2020.	Detailed Design
CHO 9	11516	Mater Hospital	New 55 (51 replacement (some from St Vincent's, Fairview) & 4 new) Bed AMHU, incl. 42 adult inpatient beds, 7 High Obs beds, & 6 Psych of Old Age Beds. Major refurb of old Mater & extend	Design Feasibility
CHO 9	11517	Swords	Provision of a purpose built 10 High Support Community Residence to provide accommodation for the residents of Carlton House. Site purchased 2021 (revenue)	Appraisal
CHO 9	11785	1D Griffith Avenue, Drumcondra	Extend (589sqm) and refurbish (360sqm) existing HSE owned building (purchased in 2021) for 3 community mental health teams and an adult 7/7 mental health day hospital.	Design Feasibility
CHO 9	11948	Connolly Hospital Blanchardstown	Installation of secure anti ligature windows, wardrobes, lockers and storage in all bedrooms in the Department of Psychiatry. Creation of additional room for NCHD's	Appraisal
CHO 9	10939B	Grangegorman - Dublin North Inner City	MH accommodation (10 bed) plus carpark in conjunction with 95 Bed CNU (Cap Ref # 11178)	Detailed Design
National	11572	National allocation for anti ligature works	National allocation for anti ligature works	Appraisal

Community Care (Capacity & Other)

CHO 1	11768	Lifford	Proposed 25 bed Community Nursing Unit (approx. 1827sqm) at Lifford to replace the existing.	Appraisal
CHO 2	12904	Ballina District Hospital	Proposed new 75 bed CNU to replace existing short stay beds at Ballina District Hospital and long stay beds at St Augustine's. Intended to progress to Detailed Design in 2024	Detailed Design
CHO 2	12905	Belmullet District Hospital	Proposed new 50 bed CNU to replace existing short stay beds at Belmullet District Hospital and long stay beds at Arus Deirbhile, Belmullet.	Detailed Design
CHO 4	11922	Heather House, St Mary's Health Campus, Cork	Refurbishment / reconfiguration of existing ground floor CNU ward to dementia specific ward to include new wander route corridor, dedicated support accommodations. 1no. bariatric bedroom with bariatric en-suite, 18no. regular bedrooms with en-suites, additional communal spaces, secure outdoor spaces.	Detailed Design
CHO 4	11963	Blarney CNU	Proposed expansion of newly completed 50 bed CNU to provide 40 further CNU beds and a 10 bed Dementia Unit (50 further beds in total)	Appraisal
CHO 6	11912	Donnybrook, Royal Hospital	Repair and uplift of three roof areas and rooms below (concert hall, main concourse and a balcony outside day room) due to leaks causing water damage.	Appraisal
CHO 7	11605	Cherry Orchard	(Phase 1) Decommission centralised boiler and heating distribution pipes for campus heating and replace with localised heating in individual buildings using high efficiency condensing gas burners-boilers. (Phase 2) Local repiping of units to include low surface radiators in acute residential units (Phase 3) Replace sub mains cabling that it no longer fit for purpose and safe	Design Feasibility
CHO 7	11630	Kilmeague Health Centre, Co. Kildare	Renovation and conversion of the vacant Kilmeague Health Centre for use as Community Daycare / Meals on Wheels run by St Vincent de Paul under SLA. Facilities would include dayroom, dining facility, toilet and showering facilities, Office, treatment room and kitchenette for use by approx. 20 clients.	Detailed Design
CHO 7	11748	Cherry Orchard	Development Control Plan for the Cherry Orchard campus. Site will be an ECC Hub (20). Also local strategy to replace CNU building Cuan Dara and Public Health labs.	Design Feasibility
CHO 7	11923	St. Vincent's Athy	Passive and active fire safety works - upgrade of Fire Detection & Alarm System, Installation of a new Addressable Emergency Lighting System, upgrade of doors, replacement of doors, fire glazing, upgrade of compartments and fire resisting barriers, fire stopping etc.	Appraisal
CHO 7	11924	Various	Completion of fire upgrade works (fire door upgrades, compartmentation/ sub-compartmentation, fire stopping, upgrades of ceilings) to 5 no. CNUs following completion of Fire Risk Assessments. (Meath CNU, Baltinglass Community Hospital, Belvilla CNU, Maynooth CNU, Cherry Orchard Hospital).	Appraisal



Appendix 2

New Projects and Projects to Progress Through Design

Funding source is the Department of Health

Hospital Group/CHO Area	Capital Reference No.	Facility	Brief Project Description	Status
CHO 7	13030	Baltinglass Community Hospital	Development of six single en-suite bedrooms within the existing buildings of Baltinglass Community Hospital. The six new bedrooms will be constructed in the location of the existing Day Care Centre and this will require the construction of a new Day Care building on the grounds of Baltinglass Community Unit to relocate the Day Care Centre.	Detailed Design
CHO 8	11725	Birr CNU	Project involves the refurbishment of the existing CNU in Birr to provide all single en-suite bedroom accommodation for residents through the construction of extensions and reconfiguration within existing multi-occupancy and two bed rooms to provide 76 single en-suite bed rooms. There are currently 12 no single en-suite bedrooms in the existing facility.	Appraisal
CHO 9	11598	St. Mary's, Phoenix Park	Refurbishment of existing rehabilitation space and refurbishment of existing lecture theatre for use as a training and education space.	Detailed Design

Primary Care

CHO 1	10162B	Nazareth House, Sligo	Nazareth House - Phase 3 - Primary Care Centre including External Works (2021)	Detailed Design
CHO 1	11254	Tubbercurry	Primary Care Centre to be delivered as HSE build - Ranked 96.	Detailed Design
CHO 1	11604	Donegal Hospice	New extension to Donegal Hospice to provide 4 No. bedrooms with family/visitor accommodation. 4 No. existing bedrooms are to be converted for administration/clinical use. Overall bed capacity will remain as existing. Funded by Donegal Hospice.	Design Feasibility
CHO 1	11728	Ballyconnell	Proposed new Primary Care Building, (incl. adult and child primary care services) Band A for population up to 10,000 with a 2 Dental Surgery facilities.	Appraisal
CHO 1	11769	Lifford	Proposed new Primary Care Centre (approx. 3000sqm) at Lifford.	Appraisal
CHO 1	11879	St. Christopher's Hospice, Cavan	HSE contribution to reconfiguration and renovation of the existing St. Christopher's Hospice (1096sq.m) and the provision of four extensions (Total 1287sq.m) to provide a 16 bed specialist palliative care unit, a palliative care hub, education and bereavement service and admin areas. Additional site works incl. car parking, roads, paths, pavings, landscaping. HSE co-funding with St. Christopher's Hospice.	Detailed Design
CHO 1	11960	Cavan	Purchase & refurb of existing building (Liberty Insurance Building, Cavan Town),	Appraisal
CHO 2	11204	Inishbofin	The provision of a new Primary Care Centre to replace the existing inadequate facility.	Design Feasibility
CHO 2	11740	Tuam	Refurb 148sq.m in existing PPP PCC to accommodate a an x-ray & ultrasound diagnostic suite (10 rooms) and audiology suite (2 rooms)	Appraisal
CHO 3	11747	St. Joseph's Hospital, Limerick	Proposed new Primary Care Building, 6200 sqm, green field site.	Appraisal
CHO 3	11950	Scariff Health Centre	Proposed extension to allow for physiotherapy suite, podiatry room, leg ulcer room, child health room, wounds room, speech and language therapy room, multipurpose group room and 2 bookable rooms. Will also allow for disability toilet, staff toilet and janitorial unit.	Appraisal
CHO 5	11770	Freshford Health Centre	Internal reconfiguration works of existing centre, including minor upgrade works and proposed new extension circa 150 sqm. Will include new clinical rooms for practice nurses and GPs; expansion of carpark and entrance realignment. Intended to progress to Detailed Design	Detailed Design
CHO 5	11799	Carrick On Suir	Amendments to existing GP Suites to accommodate incoming GP practice.	Design Feasibility
CHO 5	11962	Ballyhale Health Centre	Relocation of existing Ballyhale Health Centre to create a new larger primary care centre.	Appraisal
CHO 6	11551	Baggot Street Hospital	Seed-funding capital investment in order to realise the maximum equity from the site via the provision of Design Development Works & Demolition Works. Sale & lease back for PCC.	Design Feasibility
CHO 6	11722	Greystones PCC	Proposal is to purchase a site for a new PCC from Wicklow County Council and proceed with a design to Stage 2b (i.e. statutory approvals) with a sale and leaseback process then to follow.	Detailed Design
CHO 6	11951	Clonskeagh	Creation of a campus Development Control Plan	Appraisal
CHO 7	10090	Adamstown	Purchase and fit out of a building for use as a Primary Care Centre, in accordance with the PCC Strategy.	Appraisal
CHO 7	11160	Drimnagh - Curlew Rd	Primary Care Centre (originally on PPP list) will now be delivered as HSE build - 19 on Ranking . Includes Day Centre for Older Persons. Planning granted.	Detailed Design
CHO 7	11563	Rathmines Primary Care Centre	Site assembly by HSE for PCC location at Rathmines via property swap with DCC. Guilistan Terrace - 2,955 sqm. (DCC), Emmet Rd. HC Inchicore - 1,785 sq. m. (HSE) The HSE will pay for the Rathmines site by transferring the Emmet Rd. site and making up the difference with a payment to DCC. PCC may be through lease	Appraisal
CHO 7	11947	Sir Patrick Dun's Hospital	Public Health Labs - Repair and replace all damaged roof areas to include skylights, dome chimneys, pitch roof flashing and capping. Additionally refurb of rooms below roof that have sustained significant water damage.	Appraisal
CHO 7	11998	Merchants Quay, Dublin	Provide support to deliver a designated and supervised injection centre at Merchants Quay, Dublin. Intended to progress to Detailed Design in 2024.	Appraisal
CHO 8	10880	Mountrath	Extension to HC to provide additional accommodation (3 GP Practice in residence). Primary Care Centre (66) (Option appraisal to be carried out	Design Feasibility
CHO 8	11467	Portlaoise	New building on the St Fintan's Campus to create Portlaoise Primary Care Centre (National Ranking - 166). Awaiting App 3.4 breakdown of costs.	Detailed Design
CHO 8	11552	MRH Tullamore	The provision of a new build 20 no. single en-suite bedroom palliative care unit with associated ancillary accommodation and day services, outpatient and community home care team accommodation.	Appraisal
CHO 9	10122	Finglas	Primary Care Centre incl. purchase of site. To also accommodate Tusla, Ranked No 2.	Design Feasibility
CHO 9	11578a	1-3 and 5 Henrietta Place, Dublin 1	Refurbishment of existing building to integrate a number of social inclusion services into a single campus. Refurb/ alterations 1,015sq.m. New construction front section 672sq.m.	Appraisal



Appendix 2

New Projects and Projects to Progress Through Design

Funding source is the Department of Health

Hospital Group/CHO Area	Capital Reference No.	Facility	Brief Project Description	Status
CHO 9	11771	St. Mary's, Phoenix Park	Keltoi (750sq.m) is residential accommodation for Social Inclusion Addiction service clients. Project is a total refurbishment including the installation of en-suite WCs to 14 no. bedrooms & refurb of entire unit to meet Building Regulations (fire safety, lighting, heating, energy etc.).	Appraisal
CHO 9	11795	7 Henrietta Place, Dublin 1	Purchase & refurbishment of 7 Henrietta Place, Dublin 1 for expansion of existing accommodation and use by social inclusion services for the migrant population. Accommodation will include 2 No. clinical rooms, 4 No. consultant rooms, 2 No. dental rooms, dental x-ray and associated accommodation.	Appraisal
CHO 9	11854	Ballymun	Construction of a new 1568sqm building and the refurb of the existing Domville House (protected structure) (200sqm) to provide a mental health day hospital, accommodate mental health teams (884sqm) and dispensing and consultation teams for addiction services (884sqm).	Appraisal
CHO 9	11855	Blanchardstown	This project involves the construction of a new 1568m2 building and the demolition of the existing building (Mountview Health Centre) to provide a mental health day hospital, accommodate mental health teams (884sqm) and dispensing and consultation teams for addiction services (884sqm).	Appraisal
CHO 9	11881	St. Francis Hospice, Raheny	HSE contribution to the construction of a new 24-bed in-patient unit (8165sqm) to include new mortuary, underground carpark and clinical support facilities with bridge links to existing St. Francis Hospice Raheny buildings.	Tender
CHO 9	11921	110 Amiens Street, Dublin	Purchase & refurbishment of 110 Amiens Street for Social Inclusion and Mental Health Services to facilitate decant and surrender of City Clinic, 108-109 Amiens Street. Development of Addiction and Mental Health Dual Diagnosis, Homeless and Community Health Hub.	Appraisal
National	13097	NVRL Expansion	New building to consolidate NVRL testing platforms and human resources under one roof. Current NVRL is located a UCD with a COVID satellite at Backweston Campus.	Appraisal

Community Care (HIQA) Older Persons

CHO 1	11662	Buncrana CNU	Refurbishment (To follow Carndonagh) - 30 beds	Detailed Design
CHO 1	11424	Ramelton CNU	HIQA Compliance - Refurbishment - 30 beds	Appraisal
CHO 1	11425	St Joseph's, Stranorlar	HIQA Compliance - Refurbishment - 67 beds	Appraisal
CHO 2	11672	St Anne's CNU, Clifden	HIQA Compliance and Phase 2 - New 40 bed CNU & refurb existing for support services	Detailed Design
CHO 2	11676	Sacred Heart Hospital, Roscommon	New 50 bed Replacement Unit	Detailed Design
CHO 2	11671	Arus Ronan, Aran Islands	HIQA Compliance - Refurbishment - 12 beds	Review
CHO 3	11386	St Joseph's CNU, Ennis	Replacement (2x50 bed new build on green field site), 75 long stay, 25 short stay	Detailed Design
CHO 4	11688	St Raphael's, Youghal	HIQA Compliance - New 60 bed RCC at St. Raphael's, Youghal to replace the existing Youghal CH (38 beds) and Cois Abhann Welfare Home, Youghal (22 beds). A proposed project is an Older Person's Day Care Service (email 04/04/2024)	Detailed Design
CHO 5	11385	Gorey District Hospital	HIQA - Refurbishment - 19 beds	Appraisal
CHO 5	11333	St Patrick's Hospital & Our Lady's, Cashel	HIQA - Upgrade/Refurbishment/New Build 60 bed	Detailed Design
CHO 5	11692	Dungarvan CNU	Proposed CNU in Dungarvan area	Design Feasibility
CHO 6	10741	Leopardstown Park Hospital	Replacement 125 bed Community Nursing Unit	Detailed Design
CHO 6	10868	St Coleman's Rathdrum	95 Bed CNU to replace existing beds as per Service Priority List, PP granted.	Tender
CHO 7	10814	St. Vincent's Athy	Phase 1 of 92 Bed CNU to replace existing capacity as per Service Priority List. Phase 1 for 48 beds	Detailed Design
CHO 7	11698	Our Lady's Hospice, Harold's Cross	HIQA Compliance - Refurbishment - 89 beds	Appraisal
CHO 9	11178	Grangegorman	95 Bed CNU in conjunction with MH accommodation (10 beds) plus carpark	Detailed Design



Appendix 3

Community Care (Disability) Projects Funded in 2024

Funding source is the Department of Children, Equality, Disability, Integration & Youth

Hospital Group/CHO Area	Capital Reference No.	Facility	Brief Project Description	Status
Projects at Tender Stage, beyond Tender Stage and Contractually Committed in 2024				
CHO 3	11555	Brothers of Charity, Bawnmore	Fire Alarm and Emergency Lighting & compartmentation works in conjunction with decongregation programme, subject to lien. Phased. Works completed to 1 house by BoC	Construction
CHO 6	11787	Bakers Corner, Pottery Road, Dun Laoghaire	Refurbishment and upgrade of a unit (HSE property) at Bakers Corner to create a Disabilities Respite Unit. Unit will consist of: office, activity rooms, dining room, kitchen, stores, disabled WC, 4 no. client en-suite rooms, 1 no. staff en-suite room, staff room, sensory garden and access improvement works.	Construction
CHO 9	11420	Dublin City - Adelphi House	Refurbishment of Adelphi House, N.Circular Rd to provide accommodation for 4 Respite Beds and a separate Day Services Hub for adults with Autism.	Tender
National	11890	Minor Capital	To address Infrastructural & Clinical Risk deficits.	Construction
New Projects and Projects to Progress Through Design				
CHO 1	11439	Cleary Centre, Donegal Town	New ID Adult Day Services facility	Appraisal
CHO 1	11792	Ballyhaise	Purchase and refurbishment of a house in Antiduff, Ballyhaise, Co. Cavan to replace an existing house, Manderly Lodge. Manderly Lodge to be sold on completion of the works.	Design Feasibility
CHO 1	11814	Ballymote	Construction of a new building on a HSE owned site at Ballymote, Sligo for use as a Day care services for Sligo/ Leitrim. This building is to relocate existing services being provided by IONA Transition Programme at leased building at Cregg House.	Appraisal
CHO 1	11837	Carrick On Shannon	New build residence (385sqm) for adult (18-28 years) disability respite. Four bedrooms (three en-suite), 2 no. sitting rooms, kitchen & dining etc. and an adjoining single bedroom apartment. Proposed site is on HSE owned lands adjacent St Patricks Community Hospital, Carrick on Shannon.	Appraisal
CHO 5	11342	Kelvin Grove, Carlow	New build for Children's Therapy Services (Holy Angels) for children 0-18 with complex needs in HSE owned site in Carlow, including preschool facility & therapy pool.	Design Feasibility
CHO 5	11455	St. Otterans	New build St Otteran's Children's Therapy facility to facilitate therapy services for children and young with complex needs (incl. Sacred Heart Centre). Site aka St John's Hill. Works part funded by Touching Hearts charity.	Detailed Design
CHO 7	11742	CRC, Clondalkin	Construction of a new purpose-built facility (1400sqm) to replace existing accommodation and provide clinical disability services to children and adults within CHO 7, including Assistive Technology, Specialist Seating and other specialist services.	Appraisal
CHO 7	TBC	Various	Placeholder for site purchase costs associated with Disability Day Services i.e. Capital Ref. #11856, #11857, #11858.	Appraisal
CHO 8	11421	Portlaoise	New replacement (purchase) Community Residence for 4 ID clients- Summerhill	Appraisal
CHO 9	11419	Gracepark Road, Drumcondra, Dublin City - Childvision	Development of a National Campus of Excellence for the Visually Impaired (Partial Design Team - planning granted).	Design Feasibility
CHO 9	11520	CRC, Clontarf	Redevelopment of existing CRC Facilities, Roof & Fire Safety Works (Review & feasibility of overall site requirements)	Design Feasibility
CHO 9	11606	57 Rathbeale Road, Swords, Co Dublin	Intensive Support Disability Day Service unit - to provide day services to children entering adult services through delivering high quality, person centred day services which promote the active citizenship of all service users.	Detailed Design
CHO 9	11618	Cabra, Dublin 7	Accommodation to provide 4 bed child respite accommodation comprising 3 bedrooms, living room & recreational spaces, 1 separate studio style apartment with separate entrance.	Appraisal
CHO 9	11743	Site to be confirmed (Dublin N City, Balbriggan)	Intensive Support Disability Day Service unit (685sqm) - to provide day services to children entering adult services. Costs include assumed site purchase costs	Appraisal
CHO 9	11772	Blanchardstown (Location to be confirmed)	New building required to accommodate increased and expanding size of team (18+ WTE) (853sq.m). Building will include 2 No. clinic rooms (20sqm each) Gym (50sqm), OT Room (30 sqm), Training Room (50 sqm), Offices (140sqm), Canteen (60 sqm) and support accommodation.	Appraisal
CHO 9	11773	Kilbarrack (Location to be confirmed)	New location required to consolidate CDNT currently housed in separate locations (30 WTE).	Appraisal
CHO 9	11774	Cabra/ Grangegorman, Avista Campus	Renovation and extension to existing facility on Avista Campus, Navan Road, Dublin 7, to accommodate the existing team (25 WTE).	Appraisal
CHO 9	11775	St. Michael's House, Raheny	Proposed refurbishment and extension of existing building at St. Michael's House, Raheny Adult Day Centre. The extended building will house the existing 8 day service users from Raheny ADC and increase this to 12 No. users. The extended building will also allow for the relocation of Grangemore Local Centre into the same building and increase their users from 11 No. to 15 No. Decant building not include in costs, it is to be provided by St. Michael's House.	Appraisal
CHO 9	11789	Villa Park Gardens, Navan Road, Dublin 7	Development to accommodate Intensive Support Day Service (360sqm) for teaching teenagers and young adults how to carry out daily tasks and preparing them to enter adult life in their homes and community.	Appraisal
CHO 9	11815	Balbriggan (Location to be confirmed)	New build location required for Children's Disability Network Team (CDNT) to replace fragmented service and comply with Model of Service required.	Appraisal
CHO 9	TBC	Various	Placeholder for site purchase costs associated with Disability Day Centres i.e. Capital Ref. #11816, #11817, #11818, #11819, #11820.	Appraisal
CHO 9	TBC	Various	Placeholder for site purchase costs associated with Disability Day Services i.e. Capital Ref. #11883, #11884, #11886.	Appraisal
CHO 9	11887	Ashgrove House, Navan Road, Dublin 7	Refurbishment of existing building to include replacement of the Mechanical & Electrical Services (incl. ICT & Active Fire safety systems), upgrade of the Building Fabric and heat/energy systems.	Appraisal
National	11223	Various	Capital Allocation to allow for the upgrade of residential facilities for people with disabilities to meet HIQA standards i.e. Decongregation Programme	Various
National	11570	National allocation for Fire Safety (Disability)	National allocation for Fire Safety in community residential dwellings (Disability)	Appraisal



Appendix 4
Projects to Complete in 2024

Hospital Group/CHO Area	Capital Reference No.	Facility	Estimated Project Completion	
Acute Projects				
Dublin Midlands Hospital Group				
	11458	The Coombe Hospital	New Interim Laboratory - National Cancer Screening Service (excludes equipping)	Q3 2024
	11488	Tallaght University Hospital	Provision of a replacement Pharmacy Aseptic Compounding Unit (New submission recd Jan 22). Planning granted	Q3 2024
	11503	St. Luke's Hospital, Rathgar	New Fire Detection & Alarm System plus passive fire safety works.	Q2 2024
	11712	Portlaoise MRH	Mechanical Upgrade Works to 10 no. Existing Ventilation Systems incl Theatres 1 & 2; Paed Isolation Rooms A, E; Decontamination Unit; Endoscopy Procedure Room 1 & 2; Special Care Baby Unit Decontamination Unit, Special Care Baby Unit.	Q2 2024
	11713	St. James's Hospital	Reconfiguration of existing cardiology accommodation to provide space for a third cath lab. Equipping costs included.	Q4 2024
	11889	Mount Carmel Hospital	To develop a Surgical Hub facility for Dublin South area to include 4 No. operating theatres (2 major, 2 minor) with support accommodation, including enabling works.	Q4 2024
Ireland East Hospital Group				
	11273	Mullingar MRH	Extension to Radiology Department to accommodate an MRI being provided by others	Q1 2024
	11301	St. Vincent's University Hospital	Develop a 6 bed Critical care unit by refurbishing St Patricks Ward on the fourth floor of Block H. The new ICU ward will have direct connectivity to the existing ICU in Block N on the same Floor level which will allow for shared schedule of accommodation. Proposal replaces previous proposal.	Q4 2024
	11585	Mater Hospital	Mater Major Trauma Centre Phase 1a - Phase 1a involves the provision of 3 trauma bays, CT, interventional radiology equipment and associated ancillary accommodation to address anticipated increase in trauma demand requirements for MTC.	Q1 2024
	11648	St. Luke's Hospital, Kilkenny	Phase 4 Electrical Infrastructure Upgrade works: To upgrade the electrical infrastructure to address significant single points of failure resulting in power failure to critical clinical care areas and wards. To improve redundancy and resilience.	Q1 2024
	11649	St. Vincent's University Hospital	Day Oncology Unit. Reconfiguration of day ward (350sqm - St Anne's Day Ward) to increase the number of treatment spaces by 9 no. to a total of 28 no.	Q3 2024
	11714	Our Lady's Hospital, Navan	Upgrade of Our Lady's Hospital Electrical Power Infrastructure from a LV supply to a MV supply. Installation of a new LV Main Distribution Board & Upgrade of electrical backup provision.	Q3 2024
	11736	St. Luke's Hospital, Kilkenny	Replacement of existing CT scanner (2009) with new. Equipment cost in ERP.	Q1 2024
	11737	Wexford General Hospital (Ely Hospital)	Renovate and improve the existing Endoscopy service and old Theatre space at Ely Hospital to include 2 fully compliant endoscopy rooms and a minor procedures room.	Q3 2024
	11804	Royal Victoria Eye & Ear	Upgrade of Fire Alarm and Emergency Lighting	Q4 2024
	11805	Royal Victoria Eye & Ear	Passive Fire Safety Works	Q4 2024
	11839	St. Luke's Hospital, Kilkenny	Surgical 2 ward (29 beds) is vacant and will be refurbished to accommodate beds transferred from Surgical 1 ward. Surgical 1 ward will then be refurbished to accommodate 14 beds. Medical 1 ward is vacant and will be refurbished to accommodate 14 beds from Medical 2 ward (currently 29 beds) along with space for a Paediatric day unit.	Q4 2024
	11859	Swords Business Park	To develop a Surgical Hub facility for Dublin North area to include 4 No. operating theatres with recovery or post anaesthetic unit (including an 9-bed primary recovery unit and a further 16 beds in a second stage recover). The development shall also include an admission suite and support services and staff facilities.	Q4 2024 (Phase 1)
	13031A	Mater Hospital	National Isolation Unit made up of 2 No. Highly Infectious Disease Containment Suites.	Q3 2024



Appendix 4
Projects to Complete in 2024



Hospital Group/CHO Area	Capital Reference No.	Facility	Estimated Project Completion	
RCSI Hospital Group				
	11249B	Beaumont	Refurbishment of Rockfield House (65 spaces), St. Anne's (38 spaces) and Beaumont House (85 spaces) for use as admin accommodation. Project is an enabler to other projects.	Q4 2024
	11402	Connolly Hospital Blanchardstown	Integrated Pathology Lab (includes Biochemistry, Microbiology, Haematology, Blood Transfusion unit & Histopathology. To be developed as part of RCSI Project (Graduate Programme), payment plan agreed.	Q3 2024
	11731	Beaumont	Aspergillus Control Project. Installation of specialist ventilation systems to mitigate aspergillus risk to various immunocompromised patient cohorts during construction of large capital projects.	Q4 2024
	11763	Connolly Hospital Blanchardstown	Construction of a 4th Endoscopy procedure room (29sqm), HTM compliant AHU, associated washer and water treatment unit & changing area (3 no procedure rooms in place currently).	Q2 2024
	11807	Beaumont	Construction of a 13th Operating Theatre and associated support rooms to be located in an existing internal courtyard adjacent to the existing Operating Theatre Block. A dedicated plant room, will be constructed at First Floor level above the new theatre.	Q2 2024
	11961	Connolly Hospital Blanchardstown	Possible provision of an additional 15 beds at either the Beech or Holly wards. Scheme to be further developed at Capital Submission stage.	Q2 2024
	13007	Connolly Hospital Blanchardstown	New Project: Theatres: Theatre upgrade to allow Emergency specific theatre and consequent covid specific dedicated theatre High Priority but interim solution	Q3 2024
	13065	Cavan General Hospital	Extend OPD into Lisdarn Community Care building to provide an interim project. In addition ground floor to be used as interim ECC Hub.	Q2 2024
Saolta University Hospital Group				
	11132	Portiuncula University Hospital	New replacement Ward Block (50 Beds) to provide replacement ward accommodation in line with current standards.	Q2 2024
	11143B	Merlin Park University Hospital	The proposed project is a Ground & First floor Outpatients Department in MPUH (50 consulting rooms) to accommodate the outpatient services which are discommoded by the proposed new Emergency Department & Womens & Childrens project at UHG, and to provide capacity for outpatient services.	Q3 2024
	11393	Letterkenny University Hospital	Fire Safety Upgrade - Fire Alarm upgrade & new Emergency lighting system.	Q2 2024
	11423	Mayo University Hospital	HSSD Reconfiguration & Upgrade (including feasibility study), Equipment from ERP	Q1 2024
	11429A	Sligo University Hospital	Carpark and associated enabling works to facilitate the provision of a new Ward Block.	Q1 2024
	11587	Letterkenny University Hospital	Extension to Laboratory (Microbiology, Virology and Immunology) to provide capacity for Additional Covid 19 Testing (additional equipment and staff already in place) and to bring the Lab up to current standards (not upgraded post flooding event).	Q1 2024
	11873	Portiuncula University Hospital	Construction of 2nd MV substation incorporating 2x MV transformers, ring main unit, associated switchgear, LV supply, standby generator etc	Q2 2024
South South West Hospital Group				
	11412	Bantry General Hospital	Endoscopy Suite. Enabling works complete - MV LV upgrade	Q3 2024
	11463	University Hospital Kerry	UHK Water Infrastructure Replacement	Q2 2024
	11480	CUMH	Supply and Installation of Mechanical Air Conditioning to the Cork University Maternity Hospital (Significant Patient Safety issue - Infrastructural Risk)	Q1 2024
	11548	University Hospital Waterford	MRI Replacement and associated Fire / Infrastructure Upgrade Works (Equipment purchase in ERP).	Q1 2024
	11611	CUH	Replacement of cladding, CRC (Cardiac Renal Centre) building	Q4 2024
	11721	Mercy University Hospital	Phase 03: Electrical Infrastructure upgrade works based on the output/recommendations from various condition surveys.	Q2 2024
	13013A	Tipperary University Hospital	Works to refurbish existing accommodation to modern standards to provide 33 beds (6 no singles & 9 no 3 beds) including link corridor	Q1 2024
University of Limerick Hospital Group				
	11320	Croom Orthopaedic Hospital	Fire Upgrade Works, Passive works - Phased	Q3 2024
	11414A	University Hospital Limerick	Fire Safety Upgrade -Phase 2: Installation of a Fire Alarm & Emergency lighting system	Q3 2024
	11496	University Maternity Hospital Limerick	Neo-natal expansion, Phase 1 - relocate clinical staff to modular, complete 2021. Phase 2 - 2022 Neo natal spaces to follow	Q3 2024
	11790	Raheen, Limerick, Houston Hall	Fit out of office accommodation for use by Medical Records, HIPE, Quality & Risk, Finance etc.	Q1 2024
National				
	11199A	Dr. Steeven's Hospital - HSE HQ	Demolish HIU building, structural repairs to clock tower & boundary wall,	Q2 2024
Community Care (Disability)				
CHO 1		Cavan Lower and Sliabh Sneacht, Co. Donegal; Glencurran, Co. Cavan; Abbeyville and Hadanem House, Co. Sligo	Six units at varying stages of purchase/ refurbishment to meet housing requirements for individuals transitioning from congregated settings	Phased Delivery 2024
CHO 2		Kilbride, Parke, Mount Gordon, Áras Attracta and Cois Coille, Co. Mayo	Six units at varying stages of purchase / new build / refurbishment to meet housing requirements for individuals transitioning from congregated settings	Phased Delivery 2024



Appendix 4
Projects to Complete in 2024



Hospital Group/CHO Area	Capital Reference No.	Facility		Estimated Project Completion
CHO 3		Pallasgreen, Co. Limerick; and Dunkerrin, Co. Offaly	Four units at varying stages of purchase / new build / refurbishment to meet housing requirements for individuals transitioning from congregated settings	Phased Delivery 2024
CHO 4		Evergreen House, Cork City; Ardmoneel and Coolclogher Drive, Co. Kerry	Three units at varying stages of purchase/ refurbishment to meet housing requirements for individuals transitioning from congregated settings	Phased Delivery 2024
CHO 5		Avalon and Ballycogley House, Co. Wexford	Two units at varying stages of purchase / refurbishment to meet housing requirements for individuals transitioning from congregated settings	Phased Delivery 2024
CHO 6	11787	Bakers Corner, Pottery Road, Dun Laoghaire	Refurbishment and upgrade of a unit (HSE property) at Bakers Corner to create a Disabilities Respite Unit. Unit will consist of: office, activity rooms, dining room, kitchen, stores, disabled WC, 4 no. client en-suite rooms, 1 no. staff en-suite room, staff room, sensory garden and access improvement works.	Q2 2024
CHO 6		Hollybrook Park, Co. Wicklow	One unit of purchase/ refurbishment to meet housing requirements for individuals transitioning from congregated settings	Phased Delivery 2024
CHO 7		Abbey Park, Co. Kildare	One unit of purchase/ refurbishment to meet housing requirements for individuals transitioning from congregated settings	Phased Delivery 2024

Enhanced Community Care

CHO 5	13253	HUB 15 - Clonmel ECC Hub Interim	Refurbishment works to three existing HSE building (260sqm + 192sqm + 180sqm = 632sqm) on the grounds of St. Luke's Campus, Clonmel. Interim location for CDM hub and some primary care ICPOP and CHN services.	Q4 2024
CHO 6	13208	HUB 18 - Carrickmines	Proposed fit out costs associated with the lease of a building (Iveagh Building) (3048sqm) to allow the decant of Bray Civic Centre for use by ECC. Board Decision No.: 280122/08	Q4 2024
CHO 7	13212	HUB 20 - Cherry Orchard	Phase 1, Refurbishment of Unit 3 (Blackthorn) at Cherry Orchard to accommodate ICPOP. Works include decant of a service currently operating out of Unit 3, (Education and Training Service) to a modular building (200sqm). Phase 2, Extension at Blackthorn 200m2 modular.	Q4 2024
CHO 7	13210	HUB 19 - Our Lady's Hospice, Harolds Cross	Fit out of leased space (approx. 230sqm) at Our Lady's Hospice, Harolds Cross Campus to accommodate an interim ICPOP team.	Q1 2024
CHO 7	13214	HUB 22 - Hawthorn Building, Naas	Fit out of leased building (Hawthorn) to decant not clinical services from St Mary's (and other buildings) for use by ECC.	Q4 2024



Appendix 4
Projects to Complete in 2024

Hospital Group/CHO Area	Capital Reference No.	Facility		Estimated Project Completion
Mental Health				
CHO 2	10085A	St. Anne's Child & Adolescent Psychiatry	Extension & reconfiguration, commenced under MH Revenue, planning granted	Q2 2024
CHO 3	11919	St. Camillus's Limerick	Reconfiguration of Tearmann Unit (206sqm) to include the reduction of multi occupancy dormitories and increasing bathroom facilities on the unit. Tearmann Unit is an approved centre consisting of a 15-bed assessment unit for people with advancing dementia, psychological and behavioural symptoms.	Q3 2024
CHO 4	11920	Bantry General Hospital	Provision of reduced ligatures across the approved mental health centre addressing the regulatory findings of the MHC while providing additional communal space for residents of the Approved Centre.	Q1 2024
CHO 5	11286	St. Canice's Hospital, Kilkenny	Accommodation for Community CAMHS accommodation, refurb	Q4 2024
CHO 5	11374	Dungarvan	Purchase and replacement of dwelling at Sea Breeze, Youghal Rd, Dungarvan. Replacement accommodation (new build) for 11 (check) residents of Springmount at Dungarvan Community Hospital (Agreed with MH Commission)	Q2 2024
CHO 6	11487	Mount Carmel Campus	The provision of accommodation in the vacant convent for an Eating Disorder Specialist Hub to provide services for CHO6. Includes fit out of 215 sqm CAMHS	Q4 2024
CHO 6	11877	Elm Mount Unit St. Vincent's University Hospital	Reconfigure existing windows to reduce/remove ligature points	Q4 2024
Community Care (Capacity & Other)				
CHO 1	11631	Letterkenny	St. Conal's Refurbishment - fabric upgrade of Block R	Q1 2024
CHO 6	11724	Leopardstown Park Hospital	Replace the main electrical distribution board (DB2) serving the campus along with the existing sub distribution boards fed from DB2. The sub mains cables will also be upgraded.	Q3 2024
CHO 7	11258	Monasterevin	Drogheda St Monasterevin To renovate an existing building (dispensary) to provide accommodation for an Older Person Day services unit and PCC services.	Q2 2024
CHO 7	11340	Castle Street Clinic, 37 - 41 Castle Street, Dublin 2	To upgrade existing building to acceptable standard to continue to deliver alcohol and drugs specialist services as part of health & Social care network for 244 service users. Phased project	Q1 2024
CHO 7	11597	Cherry Orchard	Fire safety and Infection Control Risk project in Aspen, Hazel, Poplar & Beech units to address Fire Safety issues in existing elderly care units, including Dementia units. Addresses also other priority works whilst the units are vacated, including elements of rewiring and infection control / staff welfare considerations.	Q3 2024
CHO 7	11629	St. Vincent's Athy	Renovation of an existing vacant nightingale ward to convert it to a Day Care Centre. Existing Day Care Centre will relocated to the refurbished area.	Q4 2024
CHO 7	11630	Kilmeague Health Centre, Co. Kildare	Renovation and conversion of the vacant Kilmeague Health Centre for use as Community Daycare / Meals on Wheels run by St Vincent de Paul under SLA. Facilities would include dayroom, dining facility, toilet and showering facilities, Office, treatment room and kitchenette for use by approx 20 clients.	Q4 2024
CHO 8	11813	St. Brigid's, Portlaoise	General re-wiring to include replacement of main distribution boards, sub distribution boards, general lighting circuits etc.	Q1 2024



Appendix 4
Projects to Complete in 2024

Hospital Group/CHO Area	Capital Reference No.	Facility		Estimated Project Completion
Primary Care				
CHO 1	N/A	Dunfanaghy / Falcarragh	Primary Care Centre, by lease agreement	Q4 2024
CHO 2	11740	Tuam	Refurb 148sq.m in existing PPP PCC to accommodate a an x-ray & ultrasound diagnostic suite (10 rooms) and audiology suite (2 rooms)	Q1 2024
CHO 2	N/A	Portumna	Primary Care Centre, by lease agreement	Q2 2024
CHO 7	N/A	Clondalkin Village/Moorefield/Monastery (Boot Road)	Primary Care Centre, by lease agreement	Q1 2024
CHO 8	N/A	Kilbeggan	Primary Care Centre, by lease agreement	Q2 2024
CHO 9	11469	Kilbarrack Primary Care Centre	Refurbishment, reconfiguration & extension of Kilbarrack Primary Care Centre on existing PCC site	Q2 2024

Community Care (HIQA) Older Persons				
CHO1	11660	Falcarragh CNU	Refurbishment of existing unit - 35 beds	Q4 2024
CHO3	10902	St. Ita's, Newcastle West	Refurbishment & 12 additional bed extension - 66 beds	Q4 2024
CHO3	11426	St Conlon's CNU, Nenagh	New Replacement (50 bed)	Q1 2024
CHO4	10231	Kanturk	Kanturk Community Hospital Extension & Refurbishment - 33 beds	Q1 2024
CHO4	10824	Cork City	Unit 1 - 105 Bed CNU. South Lee - to replace existing long stay beds in St Finbarr's & address capacity deficit. PPP	Q4 2024
CHO4	10905	Middleton CH & Long Stay Unit	Replacement 50 bed CNU, PPP	Q3 2024
CHO4	11684	St Patrick's CH Fermoy	HIQA Compliance - Refurbishment & Extension - 71 beds	Q1 2024
CHO4	11687	St Joseph's CH, Millstreet	HIQA Compliance - Refurbishment & Extension - 22 beds	Q3 2024
CHO4	11330	Killarney CNU	Replacement via PPP, 130 bed	Q4 2024
CHO5	11332	St Columba's Hospital, Thomastown	Replacement 95 bed, PPP	Q4 2024
CHO 5	11394	Clonmel Community Nursing Unit	New 50 bed Unit (PPP)	Q3 2024
CHO8	10067	St Joseph's Hospital, Ardee	Replacement of St Joseph's Ardee - Older Persons Services (50 beds) PPP	Q3 2024
CHO8	11707	St Vincent's Care Centre, Athlone	Urgent upgrade & Replacement - 50 bed, PPP	Q3 2024



Appendix 5

Climate Action Plan - Pilot "Pathfinder" Projects

Hospital Group/CHO Area	Capital Reference No.	Facility	Brief Project Description	Status
"Pathfinder" Projects				
Dublin North East				
RCSI Hospital Group	11141a	Our Lady of Lourdes Hospital, Drogheda	Deep Energy and Carbon Retrofit Pilot Pathfinder Project in partnership with SEAI	Detailed Design
CHO 9	11141a	Lusk Community Nursing Unit, Dublin	Deep Energy and Carbon Retrofit Pilot Pathfinder Project in partnership with SEAI	Detailed Design
Dublin Mid-Leinster				
Ireland East Hospital Group	11141a	Mullingar MRH	Deep Energy and Carbon Retrofit Pilot Pathfinder Project in partnership with SEAI	Detailed Design
CHO 7	11141a	Baltinglass Community Nursing Unit	Deep Energy and Carbon Retrofit Pilot Pathfinder Project in partnership with SEAI	Detailed Design
West				
Saolta University Hospital Group	11141a	Sligo University Hospital	Deep Energy and Carbon Retrofit Pilot Pathfinder Project in partnership with SEAI	Detailed Design
CHO 2	11141a	Plunket Home Community Nursing Unit, Boyle, Co. Roscommon	Deep Energy and Carbon Retrofit Pilot Pathfinder Project in partnership with SEAI	Detailed Design
CHO 3	11141a	Nenagh Health Centre, Tipperary	Deep Energy and Carbon Retrofit Pilot Pathfinder Project in partnership with SEAI	Detailed Design
South				
Ireland East Hospital Group	11141a	Wexford General Hospital	Deep Energy and Carbon Retrofit Pilot Pathfinder Project in partnership with SEAI	Detailed Design
CHO 4	11141a	Clonakilty Community Nursing Unit, Cork	Deep Energy and Carbon Retrofit Pilot Pathfinder Project in partnership with SEAI	Detailed Design
Various	11141a	Cork Head Quarters Office & Clinical Services	Deep Energy and Carbon Retrofit Pilot Pathfinder Project in partnership with SEAI	Detailed Design